



2026 - 2028

# Destination Collection







Alaska

# What’s inside

## PRINCESS EXPERIENCE

Why Princess .....	4
Sun Princess & Star Princess .....	6
The Princess Fleet .....	8
Sanctuary Collection .....	10
Princess MedallionClass .....	12
Discover more on board and ashore .....	14 - 17
Drinks and all-inclusive packages .....	18
Dining .....	20 - 23
Entertainment .....	24 - 27
Rejuvenation .....	28
Families and groups .....	30
Celebrations .....	32
Staterooms .....	34 - 37
Important information .....	84
Car parking and transfers .....	86
Signature features .....	87

## DESTINATIONS

Northern Europe .....	38 - 47
Mediterranean .....	48 - 57
Alaska & Princess Wilderness Lodges .....	58 - 65
Caribbean .....	66 - 73
Panama Canal .....	74 - 77
Japan .....	78 - 83

## SHARE YOUR STORY

Connect with Princess and fellow guests via Facebook, YouTube, Instagram, X, Pinterest and TikTok. Share stories of your Princess adventures, watch videos and much more. #PrincessCruises



## SPECIAL OFFERS FOR YOU

Sign up or manage your preferences to receive our latest news and offers - already registered? Simply log in at [princess.com](https://princess.com) and update your preferences to ensure you receive our latest news and offers. If you’ve not yet signed up, register at [princess.com/signup](https://princess.com/signup) and be the first to hear about Princess deals.

The contents of this brochure are accurate as of January 2026 and are subject to change. Please refer to [princess.com](https://princess.com) for the most up-to-date information.



# We'll show you the world

For over 60 years, Princess Cruises has been a leader in global travel with a deep appreciation for the places we visit. Discover new destinations and choose from award-winning itineraries throughout all seven continents, and create memorable connections through cultural enrichment, regional cuisine and immersive shore excursions.



King Penguins, Falkland Islands



# Sail aboard our newest ships

Our new ships shine brighter than ever. Set sail aboard Sun Princess or Star Princess and look forward to reimagined staterooms and public spaces, dining experiences and evening entertainment.



On board Sun Princess and Star Princess you can expect:

- 4,300 guests and 21 decks
- 2,157 staterooms, including 80 Suites
- New Cove Balconies, Cabana Mini-Suites and Sanctuary Collection staterooms
- Princess Arena (990 guests) and The Dome (250 guests)
- Over 30 bars, lounges and dining venues
- 5 pools and 9 hot tubs on board

Sun Princess

## SPECTACULAR ENTERTAINMENT

Experience the mystique of Spellbound by Magic Castle and watch dazzling performances in the transformational Princess Arena, glass-enclosed Dome and light-infused Piazza.



Sun Princess, Piazza

## ENHANCED STATEROOMS

Indulge in our luxurious Sanctuary Collection experience (see pages 10-11), or spacious Cabana Deck Mini-Suites with an exclusive outdoor retreat. And all Balcony and Oceanview staterooms include a seating area with sofa.

## DELIGHTFUL DINING

Tempt your tastebuds with specialty cuts at The Butcher's Block by Dario, Teppanyaki and hot pot at Umai, and favourites like Sabatini's Italian Trattoria and Crown Grill steakhouse. At Love by Britto, art and cuisine make a delicious combination.



Love by Britto



# The Princess Fleet

## Four luxurious classes of ship

From iconic canals to the vast expanses of the world's oceans, wherever your next dream destination lies there's a perfectly sized (and styled) ship to take you there. Grouped into four distinct classes, each ship in our 17-strong fleet has its own personality. Yet each shares the same standards of service that is Princess, through and through.



### SPHERE CLASS

Making waves, our two biggest and boldest showstoppers are Sun Princess and Star Princess. Innovatively crafted and inspiring on every level, their breathtaking new spaces redefine wow-factor. Get a closer look on pages 6 and 7.

### A new dawn in ship design

- SUN PRINCESS 2024  
Guests: 4,300
- STAR PRINCESS 2025  
Guests: 4,300



📍 Sun Princess



📍 Sky Princess



📍 Sapphire Princess



📍 Coral Princess

### GRAND CLASS

Big on comfort, Grand Class is the definitive home away from home. A space for world-class entertainment and delicious dining, where our chefs love being inspired by the local delicacies of each destination.

#### Grand by name – and by nature

- RUBY PRINCESS 2008  
Guests: 3,080 | Refurbished 2023
- EMERALD PRINCESS 2007  
Guests: 3,080 | Refurbished 2025
- CROWN PRINCESS 2006  
Guests: 3,080 | Refurbished 2025
- CARIBBEAN PRINCESS 2004  
Guests: 3,140 | Refurbished 2024
- SAPPHIRE PRINCESS 2004  
Guests: 2,670 | Refurbished 2025
- DIAMOND PRINCESS 2004  
Guests: 2,670 | Refurbished 2024
- GRAND PRINCESS 1998  
Guests: 2,600 | Refurbished 2025

### ROYAL CLASS

Our Royal Class ships feature elegant staterooms and suites, and some of the largest balconies at sea. Enchanted Princess, Discovery Princess and Sky Princess are also home to Sky Suites - standout spaces that elevate the luxury experience. On all you'll find acclaimed dining and entertainment, fit for the most discerning guests.

#### The jewels in our crown

- DISCOVERY PRINCESS 2022  
Guests: 3,660 | Refurbished 2025
- ENCHANTED PRINCESS 2021  
Guests: 3,660 | Refurbished 2023
- SKY PRINCESS 2019  
Guests: 3,660 | Refurbished 2023
- MAJESTIC PRINCESS 2017  
Guests: 3,560 | Refurbished 2025
- REGAL PRINCESS 2014  
Guests: 3,560 | Refurbished 2025
- ROYAL PRINCESS 2013  
Guests: 3,560 | Refurbished 2022

### CORAL CLASS

Created for those seeking a more intimate cruise that's still big on style, attentive service and luxurious touches. Coral Class is designed to reach many of the world's off-the-beaten-track places, from the Panama Canal to Antarctica.

#### Crafted for exploring the world's treasures

- CORAL PRINCESS 2002  
Guests: 2,000 | Refurbished 2024
- ISLAND PRINCESS 2003  
Guests: 2,200 | Refurbished 2024

Learn more  
about our fleet  
at [princess.com](https://princess.com)







Sanctuary Club, Sun Princess

SANCTUARY  
COLLECTION<sup>SM</sup>

Reserve a Sanctuary Collection Suite, Mini-Suite or Balcony and you'll immediately have access to everything you see here and more:

**The top-deck Sanctuary Club**, reserved for adults (ages 16+), is the place to chill poolside, with craft cocktails, light bites, live music, pop-up surprises and that's not all.

**Dining in the Sanctuary Restaurant** Arrive at a time that is convenient for you, no reservations required. Reserved for Sanctuary Collection guests, this exclusive dining room features a custom chef's menu and dedicated waitstaff.

**Princess Premier**, our top-tier cruise package includes unlimited premium drinks, unlimited specialty and casual dining, crew appreciation, our highest-performing Wi-Fi service — MedallionNet Max — and so much more.

**Signature Suite Lounge** is a stylish retreat exclusively for Suite guests. Featuring a full bar, tasty treats and spectacular ocean views, it's perfect for relaxing day or night.

# Slip away to Sanctuary Collection



Level up your entire voyage with Sanctuary Collection, the most exclusive way to holiday, only on Sun Princess and Star Princess. This luxurious ship within-a-ship concept is filled with bespoke amenities and benefits.



Sanctuary Restaurant, Sun Princess

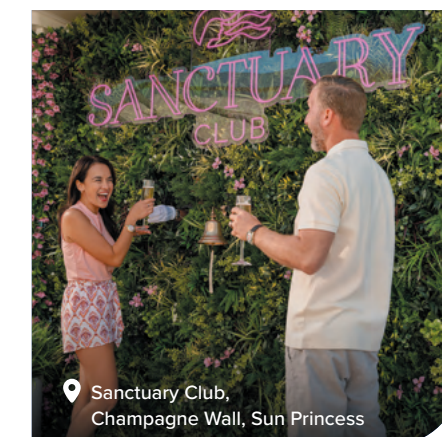

Sanctuary Club, Champagne Wall, Sun Princess



# Get more of the holiday you love

## POWERED BY MEDALLIONCLASS TECHNOLOGY FOR AN EFFORTLESS AND PERSONALISED HOLIDAY.

MedallionClass service begins with your complimentary Medallion, a ten pence-sized wearable device that connects you to what and who matters most.



### EFFORTLESS

- Food, drinks & services delivered\*
- Viewing and bookmarking activities digitally
- Touch-free boarding
- Keyless stateroom entry
- TrulyTouchless payment
- 2% onboard credit on MedallionPay purchases in select ports

### CONNECTED

- Unmatched Wi-Fi experience at sea^
- On-demand crew assistance
- Easily locate or message loved ones on board

### PERSONALISED

- Planning onboard activities
- Sharing interests, preferences for tailored service
- Crew know your name and preferences
- Customisable dining preferences and reservations

### MEMBERSHIP BENEFITS

We are humbled by the loyalty of our guests. That's why we created the Princess Captain's Circle, as a special thanks for choosing us again and again. It's easy to join, too. You become a Circle member once you complete your first Princess cruise. [Visit \*princess.com/loyalty\*](https://princess.com/loyalty) for more information.

[Learn more by visiting princess.com](https://princess.com)

\*Delivery available to selected areas onboard. Included for guests booking with Princess Plus or Princess Premier. ^Please note that depending on where our ships are sailing, you may encounter unavoidable service interruptions due to obstructions caused by geographical features. Also, in southern areas such as the Caribbean or the Mediterranean, internet speeds are often faster than those in northern areas, such as Alaska or the Baltics.



📍 Bellini's, Enchanted Princess



# It's all aboard



Hawaii, ukulele lessons

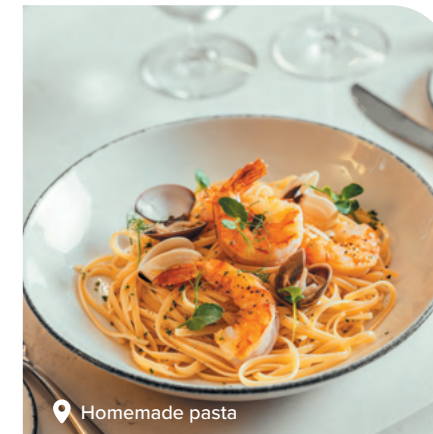

Homemade pasta

Inspired by the destinations we visit, we enhance your time on board your ship through traditional cultural performances, immersive lessons and local cuisine featured on our main dining room menus.

## HUNGRY FOR MORE?

Get to know the destinations you visit through regional flavours, like street tacos in Mexico, keftedes in Greece and homemade pasta in Italy.

## PLAY A PART

Participate in local culture and customs, like learning how to play the ukulele and craft a lei in Hawaii, being treated to a traditional Māori performance in New Zealand, and playing the steel drums in the Caribbean.

## RIGHT FROM THE SOURCE

Hear about our destinations from locals themselves. You can meet Alaskan lumberjacks, mariachi musicians in Mexico, and food and drink experts from around the world.



Whatever piques your interest in a destination, we have a shore excursion for you. Our Local Connections programme offers excursions designed by local experts for a first-person perspective. These excursions are meaningful and authentic experiences you won't find anywhere else.

**What's your excursion style?**

**IF YOU'RE A HISTORY LOVER...**

Tour the Brimstone Hill Fortress on the island of St. Kitts.

**IF YOU'RE A FOODIE...**

Savour an authentic Italian meal at a Neapolitan pizzeria.

**IF YOU'RE AN ADVENTURE SEEKER...**

Soar over the lunar-like volcanic craters of Iceland's Reykjanes Peninsula on an other-worldly helicopter experience from Reykjavik.

**IF YOU CRAVE CULTURAL IMMERSION...**

Explore the beauty of Korean culture with a city drive of Busan, taking in the best sights before learning the rituals of an ancient tea ceremony.

**IF YOU WANT TO GET CLOSER TO NATURE...**

Take a catamaran through the Beagle Channel, and observe a colony of elegant Magellanic penguins.

*Ready to explore?*

*Learn more about shore excursions at [princess.com/excursions](https://princess.com/excursions) for the best value and selection.*

# Curated excursions

Scarlet Macaw Sanctuary - Puntarenas, Costa Rica



# Here's to you!

📍 Crooners Lounge

## FILL YOUR CUP

The onboard bars and lounges mix ambience with technique and premium ingredients in equal measure. Have an unforgettable night sipping a hand-selected Cabernet from our sommelier or refresh your palate after a day of adventure with an Italian Sunset from renowned mixologist **Rob Floyd**.

## CELEBRITY SIPS

Our “Love Line Premium Liquors” collection gives you the opportunity to enjoy premium drinks — with or without alcohol — in collaboration with notable artists. Try Pantalones Organic Tequila by **Camila and Matthew McConaughey**, made with 100% organic blue Weber agave. There's also Kylie Minogue's award-winning non-alcoholic Sparkling Rosé perfect for toasting those unforgettable moments at sea.

Also in the star-studded lineup:

- Betty Buzz and Betty Booze by **Blake Lively**
- Non-alcoholic Sparkling Rosé by **Kylie Minogue**
- Sláinte Irish Whiskey by **Liev Schreiber**
- Melorosa wines by **Jason Aldean, Chuck and Kasi Wicks**
- Love Prosecco by artist **Romero Britto**
- MEILI Vodka by **Jason Momoa & Blaine Halvorson**

# Save BIG

With a Princess Premier or Princess Plus cruise package, you can do what you love on holiday without worrying about how it adds up. Enjoy drinks — including cocktails, mocktails, specialty coffees and more — plus Wi-Fi and gratuities all for one price.

**PRINCESS PREMIER®**  
**PRINCESS PLUS®**



📍 Cabana deck, Sun Princess

**Save on the things you love most** when you choose Princess Premier or Princess Plus pre-cruise instead of purchasing these items separately.

## DRINKS

Enjoy a wide array of drinks, with bar service charges included!

## GRATUITIES

We'll even take care of the crew who make you feel special.

## WI-FI

Stay connected to whatever you need with the best Wi-Fi at sea — MedallionNet Max.

## SHORE EXCURSION CREDIT & MORE

From casual and specialty dining to onboard credit to spend on shore excursions, there is so much to enjoy.

**Get more for your holiday pounds with our cruise packages**  
To learn more about what each value-packed package offers, visit:  
[princess.com/cruisepackages](https://princess.com/cruisepackages)

Princess Premier or Princess Plus packages (“Packages”) are subject to full updated terms, conditions, and restrictions, which are available at [www.princess.com/cruisepackages](https://www.princess.com/cruisepackages). One guest's participation in Package may be dependent on the other guest in their stateroom's participation, as determined by booking method, while capacity lasts. Packages and their parts may be changed or revoked at any time and are not substitutable or redeemable for cash. Cruise packages subject to change. Princess Cruise Lines, Ltd. (PCL) is not responsible or liable for technical or printing errors. Void where prohibited.

\*On cruisetours, Princess cruise packages are only available on the cruise portion. Princess cruise packages do not extend to Celebration Key.



# Love at first bite

Pasta ingredients

Whether you're sitting down to a regional dish inspired by the destination ahead or a familiar favourite from home, our chefs put quality at the heart of every bite.



## INCLUDED IN YOUR CRUISE FARE,\* YOU CAN TREAT YOURSELF TO:

- Main dining rooms
- International Café (24-hour)
- World Fresh Marketplace, The Eatery and Americana Diner
- Afternoon Tea
- Burger & Hot Dog Grill
- The Pastry Shop
- Salty Dog Grill/Café
- Swirls Ice Cream Bar
- Coffee & Cones
- Pizzeria/Slice

## DINING DESIGNED FOR YOU

Our main dining room offers three flexible options: **Traditional Dining** with early and late seatings, **Flexible Dining** or **Walk-in Anytime Dining**, so you can sit down to a meal on your own time.

Use the Princess app or dial our Dine Line at 0344 338 8671 for seamless planning:

- Book, change or update an existing reservation, including for parties greater than eight guests.
- Choose early or late seating for Traditional Dining.
- Pick your preferred time for Reservable Dining.
- Secure your seat for Specialty Dining or Experiential Dining. See pages 22-23.

**A TIP:** Experiential Dining books up quickly! Take advantage of pre-cruise reservations for 360: An Extraordinary Experience, The Chef's Table, Caymus Winemaker Dinner, wine tastings and more.

\*Charges may apply for select menu items and surcharges apply to specialty dining cover charges. Locations, features and venues may vary by ship, and actual meal times and charges are subject to change. For those travelling with children, high chairs and booster seats are available in the dining room, and our staff will provide pureed foods when requested. A kids menu and activity mat with crayons are available.



# Experiences worth savouring



## ELBOWS ON THE TABLE

Our casual dining restaurants offer our guests relaxing environments to fill their plates. Sip a pint at traditional Irish pub O'Malley's, or test the cheese pull from the pizzas at Alfredo's or Gigi's Pizzeria by Alfredo.

📍 O'Malley's Irish Pub



📍 360: An Extraordinary Experience

## EXPERIENTIAL DINING

360: An Extraordinary Experience<sup>^</sup> isn't so much a seven-course meal as it is a sensory journey through seven destinations. At The Chef's Table or Chef's Table Lumière, the Executive Chef engages with you throughout a multicourse dinner (with wine pairings, of course).

## CRAFTED WITH LOVE

The specialty dining restaurants on board are great for those special occasions — or, you know, Tuesday. Savour recipes our chefs brought over from Italy at Sabatini's Italian Trattoria. At The Catch by Rudi, satisfy all of your seafood cravings, and the Crown Grill is perfect for hand-cut, cooked-to-order steaks.



📍 The Catch by Rudi

Visit [princess.com](https://princess.com)  
for more details



Experiential, Specialty, and Casual dining venues vary by ship and are subject to change. Nominal charges apply.  
<sup>^</sup>360: An Extraordinary Experience available on Discovery Princess and Enchanted Princess.



A man and a woman are performing on stage. The man is wearing a dark vest over a black shirt and dark pants. The woman is wearing a long, flowing, light-colored dress. They are both looking upwards and singing. The background is a dark, starry space with many small, bright stars and some larger, colorful nebulae in shades of blue, green, and purple.

# Tonight's entertainment

📍 5-SKIES

## MAKE IT A PRODUCTION

Shows on board are truly West-End calibre. Catch a one-of-a-kind production of *Rock Opera*, a dazzling fusion of classic rock, opera and musical theatre inspired by avant-garde fashion; get entranced by *5-SKIES*, one of our most technologically advanced shows yet; and let local storytellers transport you at the “*Spotlight Bar*.”

## YOUR FEATURED ACT

You'll find even more star-studded talent on board, including top comedy headliners, magicians, singers, juggling artists and more.

## ENTERTAINMENT AROUND EVERY CORNER

From street performers in the Piazza, live bands poolside, nightclub karaoke and various performers dazzling lounges and bars, you'll find a surprise at every turn.

## BE DAZZLED

Prepare to be captivated on board *Star Princess* by Meridian and Illuminate, two brand-new, original theatrical spectacles that will transport you to extraordinary worlds. Or imagine yourself under a canopy of stars at our stargazing candlelight concert series in The Dome, where melodies and the cosmos combine. And elevate your night with the *Celestial Champagne Soirée* in the elegant Piazza, a sophisticated celebration under the “stars.” Plus, adding to the vibrant atmosphere, a spectacular ensemble of global performers from 24 countries is ready to bring every corner of the ship to life.

Entertainment offerings may vary by ship and are subject to change.





# Playtime perfected

📍 Plaza

While at sea, there are endless ways to spark joy and have fun.

## MOVIES UNDER THE STARS

Watch family-friendly films, concerts and sports on our 300-square-foot big screen, day or night — with complimentary popcorn. Grab a lounger, relax in a hot tub or cool off in our freshwater pools and enjoy the show.

## THE PIAZZA

In our stunning European piazza-style atrium, stroll the shops, strike up a conversation or grab a seat for an array of performers.

## JUMP RIGHT IN

Get involved in the fun with contests and trivia, or cheer on Deal or No Deal® contestants and play for your own chance to win prizes from the audience. For fun of a different flavour, try a cocktail or cooking demonstration.

## CASINO & BINGO

There is world-class gaming on board, featuring all the popular table games, slots and video poker. Step into the lounge to play a cruise ship favourite: bingo.

## THE SHOPS OF PRINCESS

Indulge in one of the finest retail experiences at sea, with top brands, attentive service and great value — because you're at sea, you can take advantage of tax and duty-free prices.



### PHOTO OPP

From timeless portraits to unforgettable events, our professional photographers transform every moment into a masterpiece. Indulge in a premium studio experience or let us capture the magic as it unfolds on board — because every journey deserves to be beautifully remembered.



# A sea of peace

Aboard a Princess cruise, you'll find several soothing spaces to rest, rejuvenate and treat yourself to quality self-care.

## LOTUS SPA

Enjoy a full-service spa for couples massages, salt stone therapy and more bespoke therapies. On select ships, you can unwind in The Enclave, our largest-ever thermal suite.

## THE SANCTUARY

This adults-only retreat is a reprieve for whatever you need. Private cabana massage? A crisp drink and a cold towel? Let our dedicated serenity stewards know and it's yours.

## POOLS & HOT TUBS

Take a dip in our pools and relax in a soothing hot tub. As you soak up the sun in a lounge, enjoy drink service and snacks poolside.

## FITNESS CENTRE

Keep your routine running with treadmills, elliptical machines and free weights, or mix things up with innovative fitness classes.



Reservations in The Sanctuary available on all ships, excluding Sun Princess and Star Princess.

📍 Enclave, Grand Princess



# Fun for everyone



📍 The Promenade, Sun Princess



📍 Kids club

Our cruises are family-friendly, and that means any family. Young kids, teens, parents, grandma and grandpa — there's fun on board for everyone.

## JUST FOR KIDS

Our Youth and Teen clubs are safe, fun spaces for kids to socialise, join in on supervised activities, and enjoy theme nights, movie nights, game tournaments and more.

## PRINCESS SPORTS CENTRAL

At Centre Court, you can play basketball, tennis, volleyball, badminton and pickleball. For more casual competition, there's also ping pong, bean-bag toss, foosball and a miniature putting green.

## PARENTS' NIGHT OUT\*

Try our affordable Group Sitting for a date night. Need supervision while in port? No problem, it's easy to organise.

## ALL TOGETHER NOW

We offer staterooms that can fit up to four guests, in all categories. For larger parties, we recommend the two-bedroom Family Suite option that fits up to eight people with upgraded amenities and a spacious sitting room. Cots are available upon request.<sup>^</sup>

## HAVE YOU MET STANLEY?

Stanley the Bear is the cuddliest bear at sea. Meet him for a special photo moment, or get your very own Stanley, exclusively in the shops of Princess.



📍 Stanley the Bear

\*Late-night group babysitting (in the centres, \$5 per child per hour) for ages 3-12 from 10 p.m.–1 a.m. Group babysitting is not available for children under 3 years. In-port supervision/programming is complimentary for children and teens aged 3-17. In-port supervision is not available for children under 3 years.

<sup>^</sup>Venues and accommodations vary by ship. Visit [princess.com](https://princess.com) for more information.



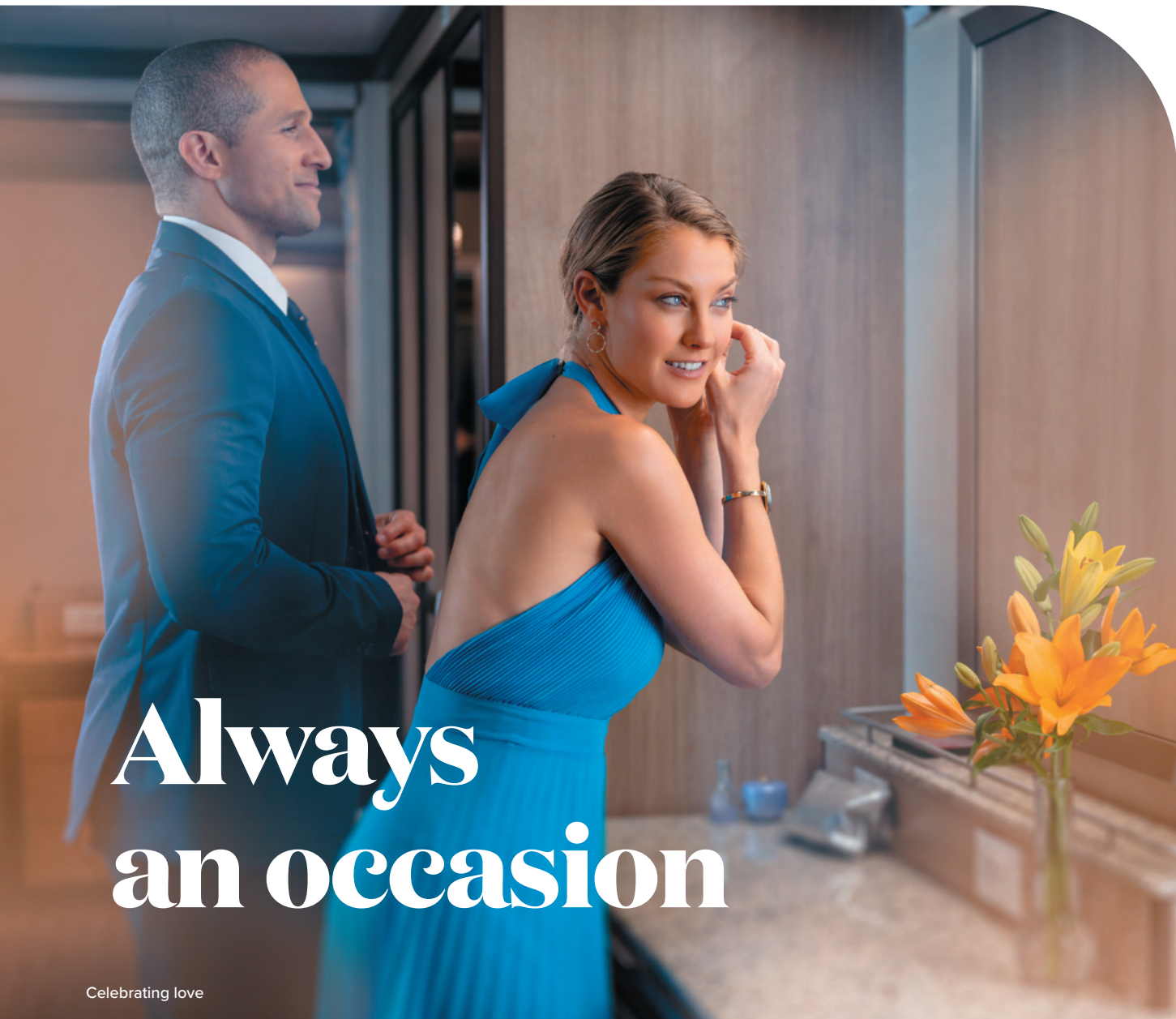

# Always an occasion

Celebrating love

Big or small, we want to make all of life's moments a celebration.

## CELEBRATING A BIRTHDAY?

It's your special day. We'll help you celebrate with a Champagne toast and birthday cake, plus – well, let's leave that a surprise.

## CELEBRATING LOVE?

Whether it's a wedding, honeymoon, anniversary or just because, you can expect plenty of romantic moments aboard the original Love Boat®.

## CELEBRATING A MILESTONE?

Mark a new phase in your life with breathtaking views, thrilling adventures and unforgettable moments.

## CELEBRATIONS AT SEA

Celebrate your favourite time of the year on board with festive decorations, holiday traditions, and special games and activities.

- Valentine's Day
- Lunar New Year
- Passover
- Easter
- Mother's Day
- Father's Day
- Diwali
- Halloween
- Thanksgiving
- Hannukah
- Christmas
- New Year



## Take luxury to a new level

Discover the Sanctuary Collection – the very best of all we have to offer, found exclusively onboard Sun Princess and Star Princess.

Step into a new world of curated amenities, private spaces and personalised service including Princess Premier, our most comprehensive all-inclusive package, fine dining at the Sanctuary Restaurant, access to the adults-only Sanctuary Club and a selection of beautifully appointed suites and staterooms.

Every detail is designed to deliver a seamless blend of relaxation and sophistication.



Whether you have your heart set on exploring the Mediterranean's vibrant culture, island-hopping in the Caribbean or glacier-viewing in Alaska, get the most value and top-tier experience by choosing Sanctuary Collection, by Princess Cruises.

The Sanctuary Collection is subject to change and is correct at time of publication.



# Your home away from home



📍 Sky Suite, Sun Princess

With thoughtfully designed spaces and premium amenities, your stateroom or Suite is your retreat at sea. Unwind after a day of adventure, sink into slumber on a bed crafted with the help of a board-certified sleep expert, and savour personalised service at your fingertips.

## SKY SUITE

Available on select ships, enjoy all the premium amenities and services of our Suites, plus:

- Expansive views from our largest balcony at sea (over 1,000 sq. ft.)
- Two bedrooms and bathrooms; sleeps up to five guests
- Pre-cruise shoreside concierge
- A dedicated Suite Experience Manager
- Private balcony viewing of Movies Under the Stars
- Sanctuary spa service on your balcony
- Private balcony stargazing
- Opportunity to host a party on your balcony
- Complimentary access to the Lotus Spa's Enclave

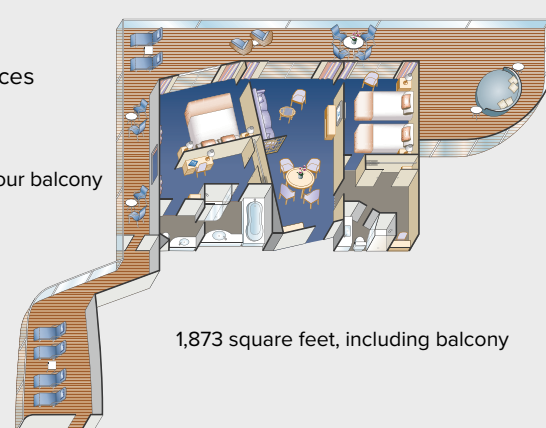

1,873 square feet, including balcony

## Accommodations you'll love



### SUITE WITH BALCONY

Includes all the fine amenities of a spacious Reserve Collection Mini-Suite, plus:

- Luxury balcony furniture
- Upgraded shower and showerhead
- Two floor to ceiling glass doors
- Separate sitting area with sofa bed, chair and tables
- One complimentary mini-bar setup\*
- Spacious closet
- Upgraded bathroom amenities
- Complimentary use of the Lotus Spa Thermal Suite™
- Laundry and professional cleaning services
- Complimentary dinner in a specialty restaurant on embarkation day<sup>^</sup>
- Priority specialty dining and shore excursion reservations
- Priority disembarkation at tender ports



Approx. 460 to 932 square feet, including balcony

\*Complimentary mini-bar setup replaces complimentary wine setup and is only available on embarkation day on cruises of 6 nights or longer. <sup>^</sup>On select ships. <sup>^</sup>Applicable on cruises six days or longer.

### RESERVE COLLECTION MINI-SUITES

This premium category includes all the standard Mini-Suite features, plus prime locations and exclusive VIP touches like upgraded amenities and services:

- Exclusive Reserve Dining within the main dining area with no reservations needed\*\*
- In-room wine setup<sup>#</sup>
- Evening canapés upon request
- Luxurious Terry shawl bathrobes

RESERVE  
COLLECTION

For more details, visit  
[princess.com/ReserveCollection](https://princess.com/ReserveCollection)

For floor plan, see Mini-Suite on next page. Reserve Collection not available on Sun Princess and Star Princess. Stateroom amenities vary by ship and are subject to change. <sup>\*\*</sup>Open every evening for dinner. Open for breakfast and lunch on sea days. <sup>#</sup>Includes a 750ml bottle of wine on embarkation day.



# Relaxing retreats

Find the configuration that suits you best. Spacious Mini-Suites, welcoming Balcony staterooms, cosy Interiors and more to fit every style and budget.



## MINI-SUITE WITH BALCONY

All the fine amenities of a Balcony stateroom plus:

- Balcony with chairs, table and ottoman
- Bathroom tub and massage showerhead\*
- Floor-to-ceiling sliding glass doors
- Separate sitting area
- Welcome glass of sparkling wine
- Sofa bed
- Luxury mattress topper and pillows
- Two flat-panel televisions

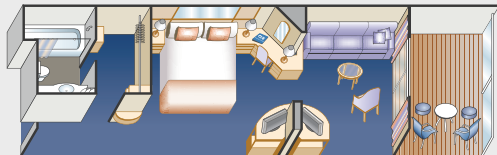

Approx. 323 square feet, including balcony

\*All accessible Mini-Suites do not include a bathtub.

## OCEANVIEW

The Oceanview stateroom includes all our standard Princess amenities plus a broad picture window to bring in light and views.

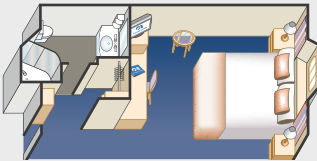

Approx. 146 to 206 square feet

Larger Deluxe Oceanview staterooms available on select ships. Note: Some categories have portholes versus picture windows. Some staterooms are partially to fully obstructed, as shown on deck plans.



## INTERIOR

Our most affordable option, the Interior stateroom features two twin beds that make up into a queen-size bed.

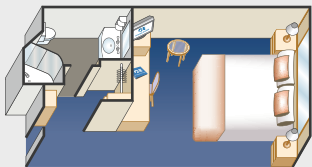

Approx. 158 to 162 square feet



## BALCONY

Enjoy a front-row seat for all the spectacular scenery on your cruise from your own balcony or indoors as you gaze through your floor-to-ceiling sliding glass door.

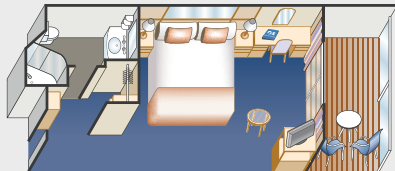

Approx. 214 to 279 square feet



Note: Floor plans, amenities, stateroom images and diagrams represent typical arrangements and may vary by ship. Certain stateroom categories may vary in size and configuration by ship. Square footage varies based on stateroom category and deck location. Stateroom views are considered unobstructed unless noted otherwise. Some categories have portholes versus picture windows. Some staterooms are partially to fully obstructed, as shown on deck plans. Obstructions do not include certain nautical items like handrails, dividers or ship hardware. For balcony staterooms, the view is determined from the perspective of the balcony railing. Balconies may have either solid steel or glass railings. Upper berth and bed ladder capacities are 250 lbs. Staterooms that can accommodate rollaways have two lower berths and one upper berth, and the staterooms can accommodate a fourth berth as a rollaway bed upon request at time of reservation. There are a limited number of rollaway beds per ship, per voyage. Use of rollaway beds restricts cabin space.



# Northern Europe

A Princess cruise is a seamless way to experience all of the destinations you dream of. Unpack only once and sail to capital cities, charming coastal villages and UNESCO World Heritage sites. Feel the love on Sky Princess and new to the region is Majestic Princess. Embark on voyages to experience the Midnight Sun, the Northern Lights and the Norwegian Fjords. On Regal Princess, discover the breathtaking landscapes and rich history of Northern Europe sailing from Copenhagen, Helsinki, Reykjavik and Southampton.

Windmills and canal in Kinderdijk, Rotterdam





Nyhavn, Copenhagen

## Norwegian Fjords

Roundtrip Southampton

7

NIGHTS

4

PORTS

**Southampton** ▶ Bergen ▶ Skjolden/Sognefjord ▶ Olden ▶ Stavanger ▶ **Southampton**

**2026 DEPARTURES**  
**Sky Princess**  
MAY 9<sup>th</sup> SAT    MAY 23 SAT    JUL 11 SAT

**2027 DEPARTURES**  
**Sky Princess**  
MAY 8<sup>th</sup> SAT    MAY 22<sup>nd</sup> SAT    JUL 10<sup>th</sup> SAT

\*Cruise operates in reverse. \*Cruise follows a different itinerary.

## Scandinavia

Roundtrip Southampton

7

NIGHTS

4

PORTS

**Southampton** ▶ Kristiansand ▶ Oslo ▶ Copenhagen **LATE NIGHT** ▶ Skagen ▶ **Southampton**

**2026 DEPARTURES**  
**Sky Princess**  
MAY 16 SAT    AUG 22 SAT

**2027 DEPARTURES**  
**Sky Princess**  
MAY 15 SAT    AUG 21 SAT

## Scandinavia

Roundtrip Southampton

7

NIGHTS

4

PORTS

**Southampton** ▶ Zeebrugge (for Brussels/Bruges) ▶ Oslo ▶ Copenhagen **LATE NIGHT** ▶ Skagen ▶ **Southampton**

**2027 DEPARTURE**  
**Sky Princess**  
JUL 17 SAT

## Ireland & England

Roundtrip Southampton

7

NIGHTS

5

PORTS

**Southampton** ▶ Cornwall (Falmouth) ▶ Cork (Cobh - For Blarney Castle) ▶ Dublin (Dun Laoghaire) ▶ Belfast ▶ Liverpool ▶ **Southampton**

**2027 DEPARTURE**  
**Majestic Princess**  
MAR 31 WED

## Norwegian Fjords

Roundtrip Southampton

7

NIGHTS

4

PORTS

**Southampton** ▶ Hardangerfjord Scenic Cruising ▶ Skjolden/Sognefjord ▶ Olden ▶ Stavanger ▶ **Southampton**

**2026 DEPARTURE**  
**Sky Princess**  
AUG 1 SAT



Olden, Norway

DISCOVER OUR NEW 2027 NORTHERN EUROPE ITINERARIES ON REGAL PRINCESS.

VISIT [PRINCESS.COM](https://princess.com) OR YOUR TRAVEL ADVISOR

### MORE INFORMATION

Fleet information, deck plans, shore excursions and port timings can be found at [princess.com](https://princess.com). Full Booking Conditions can be found at [princess.com/legal](https://princess.com/legal)

More Ashore

See the sights during the day and experience the nightlife after dark with Late Night (9 p.m. or later) or Overnight calls.

Ship Anchors Offshore

Ship anchors offshore. Guests are transported ashore free of charge via water shuttle. Wheelchair access limited.





📍 Giant's Causeway, Northern Ireland

### European Capitals

Roundtrip Southampton

10

NIGHTS

6

PORTS

**Southampton** ▶ Zeebrugge (for Brussels/Bruges) ▶ Rotterdam **LATE NIGHT** ▶ Copenhagen **LATE NIGHT** ▶ Aarhus ▶ Hamburg (for Berlin) **LATE NIGHT** ▶ Le Havre (for Paris/Normandy) ▶ **Southampton**

2026 DEPARTURES

Majestic Princess

JUN 29 MON

Sky Princess

OCT 24<sup>\*</sup> SAT

2027 DEPARTURE

Majestic Princess

JUL 2<sup>\*</sup> FRI

<sup>\*</sup>Cruise is 12 nights and follows a different itinerary. <sup>2</sup>Amsterdam replaces Rotterdam.

### British Isles with France & Belfast

Roundtrip Southampton

12

NIGHTS

9

PORTS

**Southampton** ▶ Cornwall (Falmouth) ⚓ ▶ Cork (Cobh - For Blarney Castle) ▶ Dublin (Dun Laoghaire) ⚓ ▶ Liverpool ▶ Belfast ▶ Glasgow (Greenock) ▶ Invergordon ▶ Edinburgh (South Queensferry) ⚓ ▶ Le Havre (for Paris/Normandy) ▶ **Southampton**

2026 DEPARTURE

Majestic Princess

MAY 22 FRI

2027 DEPARTURES

Majestic Princess

APR 7 WED    MAY 13 THU    JUL 12 MON    SEP 10<sup>\*</sup> FRI

APR 19 MON    MAY 25<sup>\*</sup> TUE    JUL 24 SAT

MAY 1 SAT    JUN 6<sup>\*</sup> SUN    AUG 29<sup>\*</sup> SUN

<sup>\*</sup>Cruise follows a different itinerary/order.

### British Isles with France & Belfast

Roundtrip Southampton

12

NIGHTS

9

PORTS

**Southampton** ▶ Cornwall (Falmouth) ⚓ ▶ Cork (Cobh - For Blarney Castle) ▶ Liverpool ▶ Belfast ▶ Glasgow (Greenock) ▶ Orkney Islands (Kirkwall) ▶ Invergordon ▶ Edinburgh (South Queensferry) ⚓ ▶ Le Havre (for Paris/Normandy) ▶ **Southampton**

2026 DEPARTURES

Majestic Princess

APR 28 TUE    JUL 21 TUE    SEP 7<sup>\*</sup> MON

<sup>\*</sup>Late night departure in Glasgow.

### British Isles with France & Belfast

Roundtrip Southampton

11

NIGHTS

8

PORTS

**Southampton** ▶ Cornwall (Falmouth) ⚓ ▶ Cork (Cobh - For Blarney Castle) ▶ Dublin (Dun Laoghaire) ⚓ ▶ Belfast ▶ Glasgow (Greenock) ▶ Invergordon ▶ Edinburgh (South Queensferry) ⚓ ▶ Le Havre (for Paris/Normandy) ▶ **Southampton**

2026 DEPARTURE

Majestic Princess

APR 17 FRI

### British Isles with France & Belfast

Roundtrip Southampton

12

NIGHTS

9

PORTS

**Southampton** ▶ Portland ▶ Cornwall (Falmouth) ⚓ ▶ Cork (Cobh - For Blarney Castle) ▶ Dublin (Dun Laoghaire) ⚓ ▶ Belfast ▶ Glasgow (Greenock) ▶ Orkney Islands (Kirkwall) ▶ Edinburgh (South Queensferry) ⚓ ▶ Le Havre (for Paris/Normandy) ▶ **Southampton**

2026 DEPARTURES

Majestic Princess

MAY 10 SUN    JUN 3 WED    JUL 9<sup>\*</sup> THU    AUG 26<sup>\*</sup> WED

2027 DEPARTURES

Majestic Princess

AUG 5<sup>\*</sup> THU    AUG 17<sup>\*</sup> TUE

<sup>\*</sup>Invergordon replaces Orkney Islands. <sup>2</sup>Cruise follows different itinerary.



📍 Castle, Edinburgh

**MORE INFORMATION**  
Fleet information, deck plans, shore excursions and port timings can be found at [princess.com](https://princess.com). Full Booking Conditions can be found at [princess.com/legal](https://princess.com/legal)

**More Ashore** See the sights during the day and experience the nightlife after dark with Late Night (9 p.m. or later) or Overnight calls.

⚓ Ship anchors offshore. Guests are transported ashore free of charge via water shuttle. Wheelchair access limited.





Cathedral, Helsinki

### British Isles with France & Belfast

Roundtrip Southampton

12

NIGHTS

8

PORTS

**Southampton** ▶ Invergordon ▶ Orkney Islands (Kirkwall) ▶ Stornoway ▶ Glasgow (Greenock) **LATE NIGHT** ▶ Belfast ▶ Dublin (Dun Laoghaire) ▶ Cork (Cobh - For Blarney Castle) ▶ Le Havre (for Paris/Normandy) ▶ **Southampton**

**2026 DEPARTURE**  
**Majestic Princess**  
AUG 2 SUN

### Oktoberfest European Capitals

Roundtrip Southampton

12

NIGHTS

7

PORTS

**Southampton** ▶ Zeebrugge (for Brussels/Bruges) ▶ Rotterdam ▶ Hamburg (for Berlin) **OVERNIGHT ONBOARD** ▶ Le Havre (for Paris/Normandy) ▶ **Southampton**

**2027 DEPARTURES**  
**Majestic Princess**  
SEP 22 WED    OCT 4<sup>th</sup> MON

\*Cruise operates in reverse, Aarhus replaces Oslo.

### Oktoberfest European Capitals

Roundtrip Southampton

14

NIGHTS

9

PORTS

**Southampton** ▶ Le Havre (for Paris/Normandy) ▶ Zeebrugge (for Brussels/Bruges) ▶ Rotterdam ▶ Skagen ▶ Copenhagen ▶ Aarhus ▶ Kristiansand ▶ Oslo ▶ Hamburg (for Berlin) **OVERNIGHT ONBOARD** ▶ **Southampton**

**2026 DEPARTURE**  
**Sky Princess**  
SEP 26 SAT

### British Isles with France

Roundtrip Southampton

12

NIGHTS

9

PORTS

**Southampton** ▶ Portland ▶ Cornwall (Falmouth) ▶ Cork (Cobh - For Blarney Castle) ▶ Dublin (Dun Laoghaire) ▶ Liverpool ▶ Glasgow (Greenock) **LATE NIGHT** ▶ Invergordon ▶ Edinburgh (South Queensferry) ▶ Le Havre (for Paris/Normandy) ▶ **Southampton**

**2026 DEPARTURE**  
**Majestic Princess**  
AUG 14 FRI

### Norway, Denmark & Sweden

Roundtrip Copenhagen

12

NIGHTS

9

PORTS

**Copenhagen** ▶ Visby ▶ Stockholm ▶ Helsinki **LATE NIGHT** ▶ Tallinn ▶ Riga ▶ Klaipeda ▶ Gdansk (Gdynia) ▶ Oslo ▶ Skagen ▶ **Copenhagen**

2026 DEPARTURES		2027 DEPARTURES	
<b>Sapphire Princess</b>		<b>Caribbean Princess</b>	
MAY 3 <sup>rd</sup> SUN	JUL 14 TUE	MAY 6 THU	JUL 17 SAT
MAY 15 <sup>th</sup> FRI	JUL 26 <sup>th</sup> SUN	MAY 18 TUE	JUL 29 THU
MAY 27 WED	AUG 7 <sup>th</sup> FRI	MAY 30 SUN	AUG 10 TUE
JUN 8 <sup>th</sup> MON		JUN 11 FRI	
JUN 20 <sup>th</sup> SAT		JUN 23 WED	
JUL 2 <sup>nd</sup> THU		JUL 5 MON	

\*Cruise operates in reverse and has a late night in Tallinn instead of Helsinki, and has a late night in Tallinn instead of Helsinki. \*Nynashamn (for Stockholm) replaces Stockholm. \*Cruise follows a different order. \*Bornholm replaces Klaipeda.



Canal, Bruges

#### MORE INFORMATION

Fleet information, deck plans, shore excursions and port timings can be found at [princess.com](https://princess.com). Full Booking Conditions can be found at [princess.com/legal](https://princess.com/legal)

More Ashore

See the sights during the day and experience the nightlife after dark with Late Night (9 p.m. or later) or Overnight calls.

Ship anchors offshore

Guests are transported ashore free of charge via water shuttle. Wheelchair access limited.





Kirkjufell, Grundarfjörður

### Iceland & Norway

Roundtrip Southampton

14

NIGHTS

8

PORTS

**Southampton** ▶ Haugesund ▶ Skjolden/Sognefjord ▶ Olden ▶ Ålesund ▶ Akureyri ▶ Ísafjörður ⚓ ▶ Grundarfjörður ⚓ ▶ Reykjavik ▶ **Southampton**

**2026 DEPARTURES**  
**Majestic Princess**  
JUN 15<sup>1</sup> MON

**Sky Princess**  
JUN 27 SAT

**2027 DEPARTURES**  
**Majestic Princess**  
JUN 18<sup>1</sup> FRI

**Sky Princess**  
JUN 26<sup>2</sup> SAT

<sup>1</sup>Cruise follows a different itinerary. <sup>2</sup>Cruise follows a different order.

### Search for the Northern Lights

Roundtrip Southampton

14

NIGHTS

5

PORTS

**Southampton** ▶ Ålesund ▶ Trondheim ▶ Tromsø **OVERNIGHT ONBOARD** ▶ Alta ⚓ **LATE NIGHT** ▶ Molde ▶ **Southampton**

**2026 DEPARTURE**  
**Sky Princess**  
OCT 10<sup>4,5</sup> SAT

**2027 DEPARTURES**  
**Majestic Princess**  
MAR 3 WED    MAR 17 WED    OCT 16<sup>1</sup> SAT

<sup>1</sup>Cruise follows a different order. <sup>2</sup>Overnight onboard will take place in Alta instead of Tromsø.

### Norwegian Fjords & Scandinavia

Roundtrip Southampton

14

NIGHTS

9

PORTS

**Southampton** ▶ Kristiansand ▶ Oslo ▶ Copenhagen **LATE NIGHT** ▶ Skagen ▶ Southampton ▶ Bergen ▶ Skjolden/Sognefjord ▶ Olden ▶ Stavanger ▶ **Southampton**

**2026 DEPARTURES**  
**Sky Princess**  
MAY 9<sup>1</sup> SAT    MAY 16 SAT

**2027 DEPARTURES**  
**Sky Princess**  
MAY 8<sup>1</sup> SAT    MAY 15<sup>2</sup> SAT    JUL 10<sup>3</sup> SAT

<sup>1</sup>Cruise follows different itinerary. <sup>2</sup>Cruise follows a different order.

### Iceandic Fjords & British Isles

Roundtrip Southampton

14

NIGHTS

9

PORTS

**Southampton** ▶ Portland ▶ Cork (Cobh - For Blarney Castle) ▶ Reykjavik ▶ Grundarfjörður ⚓ ▶ Ísafjörður ⚓ ▶ Akureyri ▶ Shetland Islands (Lerwick) ⚓ ▶ Orkney Islands (Kirkwall) ▶ Zeebrugge (for Brussels/Bruges) ▶ **Southampton**

**2026 DEPARTURE**  
**Sky Princess**  
AUG 29 SAT

### Norway, Denmark & Sweden

Roundtrip Southampton

14

NIGHTS

8

PORTS

**Southampton** ▶ Skagen ▶ Copenhagen ▶ Warnemünde (for Berlin) **LATE NIGHT** ▶ Tallinn ▶ Helsinki ▶ Stockholm **OVERNIGHT ONBOARD** ▶ Visby ▶ Kristiansand ▶ **Southampton**

**2026 DEPARTURES**  
**Sky Princess**  
APR 25<sup>1</sup> SAT    MAY 30 SAT    SEP 12<sup>2</sup> SAT

**2027 DEPARTURES**  
**Sky Princess**  
APR 24 SAT    MAY 29 SAT    SEP 11 SAT

<sup>1</sup>Cruise follows a different itinerary.

### Land of the Midnight Sun & Summer Solstice

Roundtrip Southampton

14

NIGHTS

8

PORTS

**Southampton** ▶ Stavanger ▶ Haugesund ▶ Skjolden/Sognefjord ▶ Olden ▶ Trondheim ▶ Honningsvåg (for North Cape) ▶ Tromsø ▶ Edinburgh (South Queensferry) ⚓ ▶ **Southampton**

**2026 DEPARTURE**  
**Sky Princess**  
JUN 13 SAT

**2027 DEPARTURE**  
**Sky Princess**  
JUN 12<sup>1</sup> SAT

<sup>1</sup>Cruise follows a different itinerary.



Northern Lights, Tromsø

**MORE INFORMATION**  
Fleet information, deck plans, shore excursions and port timings can be found at [princess.com](https://princess.com). Full Booking Conditions can be found at [princess.com/legal](https://princess.com/legal)

**More Ashore** See the sights during the day and experience the nightlife after dark with Late Night (9 p.m. or later) or Overnight calls.

⚓ Ship anchors offshore. Guests are transported ashore free of charge via water shuttle. Wheelchair access limited.



# Mediterranean

Ready to immerse yourself in the Mediterranean's vibrant cuisine and rich culture? Whether you fly in or sail from Southampton, and whether you're with family, a partner, or solo, you'll discover breathtaking coastlines and iconic cities like Athens, Barcelona, and Florence. Explore the homes of Greek gods and Italian artists, uncover legends at the Acropolis, admire relics at Dubrovnik's Cathedral, or climb the Leaning Tower of Pisa for stunning emerald views.



📍 Cinque Terre, Italy



Mediterranean



Ephesus, Turkey

### Spain & France

Roundtrip Southampton

7

NIGHTS

4

PORTS

**Southampton** ▶ La Coruna (for Santiago de Compostela) ▶ Bilbao ▶ Le Verdon (for Bordeaux) ▶ Cherbourg ▶ **Southampton**

**2026 DEPARTURE**  
**Sky Princess**  
MAR 23 MON

**2027 DEPARTURE**  
**Sky Princess**  
MAR 22 MON

### Greece & Adriatic Sampler

Roundtrip Civitavecchia (for Rome)

5

NIGHTS

2

PORTS

**Civitavecchia (for Rome)** ▶ Kotor ⚓ ▶ Corfu ▶ **Civitavecchia (for Rome)**

**2026 DEPARTURE**  
**Enchanted Princess**  
APR 10 FRI

### Mediterranean with Total Solar Eclipse

Barcelona to Civitavecchia (for Rome)

7

NIGHTS

3

PORTS

**Barcelona** ▶ Gibraltar ▶ Cartagena ▶ Total Solar Eclipse ▶ La Spezia (for Florence/Pisa) ▶ **Civitavecchia (for Rome)**

**2026 DEPARTURE**  
**Sun Princess**  
AUG 8 SAT

Mediterranean					
NIGHTS	ITINERARY	PORTS	SHIP	2026	2027
7	Mediterranean with Italy & Turkey	<b>Civitavecchia (for Rome)</b> ▶ Naples (for Capri & Pompeii) ▶ Crete (Chania) ▶ Kusadasi (for Ephesus) ▶ Mykonos <b>LATE NIGHT</b> ▶ <b>Athens (Piraeus)</b>	<b>Sun Princess</b>	APR 11 SAT MAY 2 SAT MAY 23 SAT JUN 13 SAT JUL 4 SAT JUL 25 SAT AUG 15 SAT SEP 5 SAT SEP 26 SAT OCT 17 SAT	APR 18 SUN MAY 9 SUN MAY 30 SUN AUG 22 SUN SEP 12 SUN OCT 3 SUN OCT 24 SUN
7	Mediterranean & Aegean	<b>Civitavecchia (for Rome)</b> ▶ Amalfi Coast (Salerno) ▶ Santorini ▶ Kusadasi (for Ephesus) ▶ Katakolon (for Olympia) <b>LATE NIGHT</b> ▶ <b>Civitavecchia (for Rome)</b>	<b>Enchanted Princess</b>	APR 25 SAT MAY 12 <sup>3</sup> TUE MAY 26 TUE JUN 9 TUE JUN 23 TUE JUL 7 TUE JUL 21 TUE AUG 18 TUE SEP 1 TUE OCT 13 TUE NOV 10 TUE	JUN 12 SAT JUN 26 SAT JUL 10 SAT AUG 7 SAT NOV 6 SAT
7	Mediterranean & Adriatic	<b>Civitavecchia (for Rome)</b> ▶ Corfu ▶ Dubrovnik ▶ Kotor ⚓ ▶ Naples (for Capri & Pompeii) ▶ <b>Civitavecchia (for Rome)</b>	<b>Sapphire Princess</b>  <b>Enchanted Princess</b>	MAR 8 SUN MAR 22 SUN APR 5 SUN  MAY 19 TUE JUN 2 TUE JUN 16 TUE JUN 30 TUE JUL 14 TUE JUL 28 TUE AUG 25 TUE SEP 8 TUE OCT 6 TUE	    JUN 19 <sup>1</sup> SAT JUL 3 <sup>1</sup> SAT JUL 17 <sup>1</sup> SAT NOV 13 <sup>1</sup> SAT
7	Mediterranean with Greece & Italy	<b>Civitavecchia (for Rome)</b> ▶ Sarandë ⚓ ▶ Katakolon (for Olympia) ▶ Valletta <b>LATE NIGHT</b> ▶ Sicily (Catania) ▶ Naples (for Capri & Pompeii) ▶ <b>Civitavecchia (for Rome)</b>	<b>Sapphire Princess</b>	MAR 15 SUN MAR 29 SUN APR 12 SUN	
7	Mediterranean with Greece & Adriatic	<b>Athens (Piraeus)</b> ▶ Santorini ⚓ ▶ Bar ▶ Corfu ▶ Sicily (Messina) ▶ <b>Barcelona</b>	<b>Sun Princess</b>	MAR 28 SAT APR 18 SAT MAY 9 <sup>1</sup> SAT MAY 30 SAT JUN 20 SAT JUL 11 SAT AUG 1 SAT AUG 22 SAT SEP 12 SAT OCT 3 <sup>1,2</sup> SAT OCT 24 <sup>1,2</sup> SAT	APR 25 SUN MAY 16 SUN JUN 6 SUN AUG 29 SUN SEP 19 SUN OCT 10 SUN OCT 31 SUN
7	Western Mediterranean with Italy	<b>Barcelona</b> ▶ Mallorca (Palma) ▶ Marseille (Provence) ▶ Corsica (Ajaccio) ▶ Genoa (for Cinque Terre) ▶ La Spezia (for Florence/Pisa) <b>OVERNIGHT ONBOARD</b> ▶ <b>Civitavecchia (for Rome)</b>	<b>Sun Princess</b>	APR 4 SAT APR 25 <sup>1</sup> SAT MAY 16 <sup>1</sup> SAT JUN 6 SAT JUN 27 SAT JUL 18 <sup>1</sup> SAT AUG 29 SAT SEP 19 <sup>1</sup> SAT OCT 10 <sup>1</sup> SAT	APR 11 SUN MAY 2 <sup>1</sup> SUN MAY 23 <sup>1</sup> SUN AUG 15 <sup>1</sup> SUN SEP 5 SUN SEP 26 <sup>1</sup> SUN OCT 17 <sup>1</sup> SUN
7	Mediterranean with France & Italy	<b>Barcelona</b> ▶ Gibraltar ▶ Marseille (Provence) ▶ Genoa (for Cinque Terre) ▶ Livorno (for Florence/Pisa) ▶ <b>Civitavecchia (for Rome)</b>	<b>Sapphire Princess</b>	MAR 1 SUN	

<sup>1</sup>Cruise follows a different order/itinerary. <sup>2</sup>Naples replaces Santorini. <sup>3</sup>Naples replaces Salerno.

MORE INFORMATION

Fleet information, deck plans, shore excursions and port timings can be found at [princess.com](https://princess.com). Full Booking Conditions can be found at [princess.com/legal](https://princess.com/legal)

More Ashore

See the sights during the day and experience the nightlife after dark with Late Night (9 p.m. or later) or Overnight calls.



Ship anchors offshore. Guests are transported ashore free of charge via water shuttle. Wheelchair access limited.



Mediterranean

Mediterranean						
NIGHTS	ITINERARY	PORTS	SHIP	2026	2027	
10	Mediterranean & Adriatic	<b>Civitavecchia (for Rome)</b> ▶ Corfu ▶ Bar ▶ Split ▶ Crete (Chania) ▶ Katakolon (for Olympia) ▶ Valletta <b>LATE NIGHT</b> ▶ <b>Civitavecchia (for Rome)</b>	<b>Enchanted Princess</b>	MAY 2 SAT		
10	Mediterranean with Greek Isles & Turkey	<b>Athens (Piraeus)</b> ▶ Bar ▶ Corfu ▶ Sicily (Messina) ▶ Santorini ⚓ <b>LATE NIGHT</b> ▶ Mykonos <b>LATE NIGHT</b> ▶ Kusadasi (for Ephesus) ▶ <b>Istanbul OVERNIGHT ONBOARD</b>	<b>Sun Princess</b>		JUN 24 THU JUL 25 SUN	
10	Mediterranean with Greek Isles & Italy	<b>Barcelona</b> ▶ Marseille (Provence) ▶ Genoa (for Cinque Terre) ▶ Civitavecchia (for Rome) ▶ Naples (for Capri & Pompeii) ▶ Crete (Heraklion) ▶ Santorini ⚓ <b>LATE NIGHT</b> ▶ Kusadasi (for Ephesus) ▶ Mykonos <b>LATE NIGHT</b> ▶ <b>Athens (Piraeus)</b>	<b>Sun Princess</b>		JUL 15 THU	
10	Mediterranean with Greek Isles & Italy	<b>Civitavecchia (for Rome)</b> ▶ Naples (for Capri & Pompeii) ▶ Dubrovnik ▶ Split ▶ Kotor ⚓ ▶ Corfu ▶ Katakolon (for Olympia) ▶ Crete (Heraklion) ▶ Mykonos ▶ <b>Athens (Piraeus)</b>	<b>Enchanted Princess</b>	SEP 15 TUE		
10	Mediterranean with Greek Isles & Adriatic	<b>Athens (Piraeus)</b> ▶ Santorini ⚓ ▶ Crete (Chania) ▶ Katakolon (for Olympia) ▶ Corfu ▶ Split ▶ Dubrovnik ▶ Kotor ⚓ ▶ Naples (for Capri & Pompeii) ▶ <b>Civitavecchia (for Rome)</b>	<b>Enchanted Princess</b>	OCT 31 SAT		
11	Mediterranean with Greek Isles & Turkey	<b>Athens (Piraeus)</b> ▶ Santorini ⚓ ▶ Kusadasi (for Ephesus) ▶ Istanbul <b>OVERIGHT ONBOARD</b> ▶ Rhodes ▶ Sicily (Messina) ▶ Valletta <b>LATE NIGHT</b> ▶ <b>Civitavecchia (for Rome)</b>	<b>Enchanted Princess</b>	SEP 25 FRI		
11	Mediterranean with Greek Isles & Italy	<b>Civitavecchia (for Rome)</b> ▶ Sardinia (Alghero) ⚓ ▶ Genoa (for Cinque Terre) ▶ Livorno (for Florence/Pisa) ▶ Valletta <b>LATE NIGHT</b> ▶ Sicily (Messina) ▶ Mykonos <b>LATE NIGHT</b> ▶ Rhodes ▶ Kusadasi (for Ephesus) ▶ <b>Athens (Piraeus)</b>	<b>Enchanted Princess</b>	OCT 20 TUE		
11	Mediterranean with Greek Isles & Italy	<b>Barcelona</b> ▶ Marseille (Provence) ▶ Genoa (for Cinque Terre) ▶ Civitavecchia (for Rome) ▶ Naples (for Capri & Pompeii) ▶ Bar ▶ Corfu ▶ Crete (Chania) ▶ Mykonos <b>LATE NIGHT</b> ▶ <b>Athens (Piraeus)</b>	<b>Sun Princess</b>		JUN 13 SUN	
11	Mediterranean with Greek Isles & Italy	<b>Istanbul OVERNIGHT ONBOARD</b> ▶ Kusadasi (for Ephesus) ▶ Rhodes ▶ Mykonos <b>LATE NIGHT</b> ▶ Crete (Chania) ▶ Valletta <b>LATE NIGHT</b> ▶ Sicily (Palermo) ▶ Sicily (Messina) ▶ Naples (for Capri & Pompeii) ▶ <b>Civitavecchia (for Rome)</b>	<b>Enchanted Princess</b>	JUN 1 <sup>1</sup> TUE SEP 14 <sup>1</sup> TUE OCT 26 <sup>2</sup> TUE		
11	Mediterranean with Greek Isles & Italy	<b>Istanbul OVERNIGHT ONBOARD</b> ▶ Kusadasi (for Ephesus) ▶ Santorini ⚓ <b>LATE NIGHT</b> ▶ Mykonos <b>LATE NIGHT</b> ▶ Crete (Chania) ▶ Sicily (Messina) ▶ Naples (for Capri & Pompeii) ▶ Civitavecchia (for Rome) <b>LATE NIGHT</b> ▶ <b>Barcelona</b>	<b>Sun Princess</b>	JUL 4 SUN AUG 4 WED		
<sup>1</sup> Valletta is not a late night call. <sup>2</sup> Sicily (Messina) comes before Sicily (Palermo).						



Leaning Tower, Pisa



Little Venice, Mykonos

### Mediterranean with Italy & Croatia

*Civitavecchia (for Rome) to Trieste (for Venice)*

**Civitavecchia (for Rome)** ▶ Livorno (for Florence/Pisa) ▶ Corsica (Ajaccio) ▶ Sardinia (Alghero) ⚓ ▶ Valletta **LATE NIGHT** ▶ Kotor ⚓ ▶ Dubrovnik ▶ Split ▶ **Trieste (for Venice)**

10  
NIGHTS

7  
PORTS

**2027 DEPARTURES**

**Enchanted Princess**

MAY 1<sup>3</sup> SAT  
AUG 14<sup>4</sup> SAT  
SEP 25 SAT

<sup>3</sup>Bar replaces Kotor. <sup>4</sup>Cruise follows a different order and Sicily (Messina) replaces Sardinia (Alghero).

### Mediterranean with Greek Isles & Turkey

*Athens (Piraeus) to Istanbul*

**Athens (Piraeus)** ▶ Crete (Chania) ▶ Katakolon (for Olympia) ▶ Sicily (Messina) ▶ Valletta ▶ Santorini ⚓ **LATE NIGHT** ▶ Mykonos **LATE NIGHT** ▶ Kusadasi (for Ephesus) ▶ **Istanbul OVERNIGHT ONBOARD**

10  
NIGHTS

7  
PORTS

**2027 DEPARTURES**

**Enchanted Princess**

MAY 22 SAT  
SEP 4<sup>5</sup> SAT  
OCT 16 SAT

<sup>5</sup>Cruise follows a different order.

### Mediterranean with Greek Isles & Adriatic

*Trieste (for Venice) to Athens (Piraeus)*

**Trieste (for Venice)** ▶ Split **LATE NIGHT** ▶ Kotor ⚓ ▶ Corfu ▶ Katakolon (for Olympia) ▶ Crete (Chania) ▶ Santorini ⚓ ▶ Rhodes ▶ Limassol **LATE NIGHT** ▶ Kusadasi (for Ephesus) ▶ **Athens (Piraeus)**

11  
NIGHTS

9  
PORTS

**2027 DEPARTURES**

**Enchanted Princess**

MAY 11 TUE  
AUG 24 TUE  
OCT 5 TUE

### Canary Islands

*Roundtrip Southampton*

**Southampton** ▶ Vigo (for Santiago de Compostela) ▶ Madeira (Funchal) ▶ Santa Cruz De Tenerife **LATE NIGHT** ▶ Gran Canaria (Las Palmas) **LATE NIGHT** ▶ Lanzarote (Arrecife) ▶ Lisbon ▶ **Southampton**

12  
NIGHTS

6  
PORTS

**2026 DEPARTURE**

**Sky Princess**

MAR 30 MON

**2027 DEPARTURE**

**Sky Princess**

APR 12 MON

**MORE INFORMATION**  
Fleet information, deck plans, shore excursions and port timings can be found at [princess.com](#). Full Booking Conditions can be found at [princess.com/legal](#)

- More Ashore

See the sights during the day and experience the nightlife after dark with Late Night (9 p.m. or later) or Overnight calls.
- ⚓

Ship anchors offshore. Guests are transported ashore free of charge via water shuttle. Wheelchair access limited.



Mediterranean

Spain, France & Portugal  
with Total Solar Eclipse

Roundtrip Southampton

14  
NIGHTS

7  
PORTS

**Southampton** ▶ Cherbourg ▶ Bilbao ▶ Total Solar Eclipse ▶ Malaga ▶ Cartagena ▶ Gibraltar ▶ Lisbon **LATE NIGHT** ▶ La Coruna (for Santiago de Compostela) ▶ **Southampton**

2026 DEPARTURE

Sky Princess

AUG 8 SAT

2027 DEPARTURE

Sky Princess

JUL 24<sup>1</sup> SAT

<sup>1</sup>Cruise follows a different itinerary.

Mediterranean & Adriatic  
with Total Solar Eclipse

Roundtrip Civitavecchia (for Rome)

14  
NIGHTS

9  
PORTS

**Civitavecchia (for Rome)** ▶ Naples (for Capri & Pompeii) ▶ Kotor ↓ ▶ Dubrovnik ▶ Corfu ▶ Sicily (Messina) ▶ Sicily (Palermo) ▶ Total Solar Eclipse ▶ Gibraltar ▶ Alicante ▶ Barcelona **LATE NIGHT** ▶ **Civitavecchia (for Rome)**

2026 DEPARTURE

Enchanted Princess

AUG 4 TUE

Mediterranean with  
Greece, Turkey, & Adriatic

Civitavecchia (for Rome) to Barcelona

14  
NIGHTS

9  
PORTS

**Civitavecchia (for Rome)** ▶ Naples (for Capri & Pompeii) ▶ Crete (Chania) ▶ Kusadasi (for Ephesus) ▶ Mykonos **LATE NIGHT** ▶ Athens (Piraeus) ▶ Santorini ↓ ▶ Bar ▶ Corfu ▶ Sicily (Messina) ▶ **Barcelona**

2026 DEPARTURES

Sun Princess

APR 11 SAT   JUN 13 SAT   AUG 15 SAT   OCT 17<sup>2</sup> SAT  
MAY 2 SAT   JUL 4 SAT   SEP 5 SAT  
MAY 23<sup>2</sup> SAT   JUL 25 SAT   SEP 26<sup>2</sup> SAT

2027 DEPARTURES

Sun Princess

APR 18 SUN   MAY 30 SUN   SEP 12 SUN   OCT 24 SUN  
MAY 9 SUN   AUG 22 SUN   OCT 3 SUN

<sup>2</sup>Cruise follows a different itinerary.

Mediterranean with  
Total Solar Eclipse

Roundtrip Civitavecchia (for Rome)

14  
NIGHTS

10  
PORTS

**Civitavecchia (for Rome)** ▶ Livorno (for Florence/Pisa) ▶ Genoa (for Cinque Terre) ▶ Marseille (Provence) ▶ Barcelona **LATE NIGHT** ▶ Mallorca (Palma) ▶ Cartagena ▶ Malaga ▶ Gibraltar ▶ Total Solar Eclipse ▶ Sicily (Palermo) ▶ Naples (for Capri & Pompeii) ▶ **Civitavecchia (for Rome)**

2027 DEPARTURE

Enchanted Princess

JUL 24 SAT



Mediterranean					
NIGHTS	ITINERARY	PORTS	SHIP	2026	2027
14	Mediterranean with Greece, Italy & Croatia	<b>Civitavecchia (for Rome)</b> ▶ Corfu ▶ Dubrovnik ▶ Kotor ↓ ▶ Naples (for Capri & Pompeii) ▶ Civitavecchia (for Rome) ▶ Sarandë ↓ ▶ Katakolon (for Olympia) ▶ Valletta <b>LATE NIGHT</b> ▶ Sicily (Catania) ▶ Naples (for Capri & Pompeii) ▶ <b>Civitavecchia (for Rome)</b>	<b>Sapphire Princess</b>	MAR 8 SUN MAR 15 <sup>4</sup> SUN MAR 22 SUN MAR 29 SUN APR 5 SUN	
14	Mediterranean, Aegean & Adriatic	<b>Civitavecchia (for Rome)</b> ▶ Corfu ▶ Dubrovnik ▶ Kotor ↓ ▶ Naples (for Capri & Pompeii) ▶ Civitavecchia (for Rome) ▶ Amalfi Coast (Salerno) ▶ Santorini ↓ ▶ Kusadasi (for Ephesus) ▶ Katakolon (for Olympia) <b>LATE NIGHT</b> ▶ <b>Civitavecchia (for Rome)</b>	<b>Enchanted Princess</b>	MAY 19 TUE MAY 26 <sup>4</sup> TUE JUN 2 TUE JUN 9 <sup>4</sup> TUE JUN 16 TUE JUN 23 <sup>4</sup> TUE JUN 30 TUE JUL 7 <sup>4</sup> TUE JUL 14 TUE JUL 21 <sup>4</sup> TUE AUG 18 <sup>4</sup> TUE AUG 25 TUE SEP 1 <sup>4</sup> TUE OCT 6 TUE	JUN 12 <sup>4</sup> SAT JUN 19 <sup>4</sup> SAT JUN 26 <sup>4</sup> SAT JUL 3 <sup>4</sup> SAT JUL 10 <sup>4</sup> SAT
14	Mediterranean, Aegean & Adriatic	<b>Civitavecchia (for Rome)</b> ▶ Naples (for Capri & Pompeii) ▶ Santorini ↓ ▶ Kusadasi (for Ephesus) ▶ Katakolon (for Olympia) <b>LATE NIGHT</b> ▶ Civitavecchia (for Rome) ▶ Corfu ▶ Kotor ↓ ▶ Dubrovnik ▶ Naples (for Capri & Pompeii) ▶ <b>Civitavecchia (for Rome)</b>	<b>Enchanted Princess</b>		NOV 6 SAT
14	Western Mediterranean with Greece & Italy	<b>Athens (Piraeus)</b> ▶ Santorini ↓ ▶ Bar ▶ Corfu ▶ Sicily (Messina) ▶ Barcelona ▶ Mallorca (Palma) ▶ Marseille (Provence) ▶ Corsica (Ajaccio) ▶ Genoa (for Cinque Terre) ▶ La Spezia (for Florence/Pisa) <b>OVERNIGHT ONBOARD</b> ▶ <b>Civitavecchia (for Rome)</b>	<b>Sun Princess</b>	MAR 28 SAT APR 18 <sup>3</sup> SAT MAY 9 <sup>3</sup> SAT MAY 30 <sup>3</sup> SAT JUN 20 <sup>3</sup> SAT JUL 11 <sup>3</sup> SAT AUG 13 <sup>5</sup> SAT AUG 22 SAT SEP 12 <sup>3</sup> SAT OCT 3 <sup>3</sup> SAT	APR 25 <sup>3</sup> SUN MAY 16 <sup>3</sup> SUN AUG 29 SUN SEP 19 <sup>3</sup> SUN OCT 10 <sup>3</sup> SUN
<sup>3</sup> Cruise follows a different itinerary. <sup>4</sup> Cruise follows a different order. <sup>5</sup> Total Solar Eclipse voyage.					

**MORE INFORMATION**  
Fleet information, deck plans, shore excursions and port timings can be found at [princess.com](https://princess.com). Full Booking Conditions can be found at [princess.com/legal](https://princess.com/legal)

**More Ashore** See the sights during the day and experience the nightlife after dark with Late Night (9 p.m. or later) or Overnight calls.

↓ Ship anchors offshore. Guests are transported ashore free of charge via water shuttle. Wheelchair access limited.



Mediterranean

### Mediterranean Adventurer

Roundtrip Southampton

14

NIGHTS

6

PORTS

**Southampton** ▶ Seville (Cadiz) ▶ Barcelona ▶ Toulon/Provence (La Seyne) ▶ Livorno (for Florence/Pisa) ▶ Civitavecchia (for Rome) ▶ Corsica (Ajaccio) ▶ **Southampton**

2026 DEPARTURES

Sky Princess

APR 11 SAT

JUL 18 SAT

2027 DEPARTURES

Sky Princess

MAR 29 MON

AUG 7<sup>1</sup> SAT

AUG 28<sup>1</sup> SAT

<sup>1</sup>Sardinia (Alghero) ↓ replaces Corsica (Ajaccio).

### Mediterranean with Greece, France & Italy

Roundtrip Barcelona

16

NIGHTS

12

PORTS

**Barcelona** ▶ Marseille (Provence) ▶ Genoa (for Cinque Terre) ▶ Civitavecchia (for Rome) ▶ Naples (for Capri & Pompeii) ▶ Santorini ↓ ▶ Kusadasi (for Ephesus) ▶ Crete (Chania) ▶ Athens (Piraeus) ▶ Santorini ↓ ▶ Bar ▶ Corfu ▶ Sicily (Messina) ▶ **Barcelona**

2026 DEPARTURE

Sun Princess

MAR 19 THU

### Mediterranean with Greece, France & Turkey

Barcelona to Athens (Piraeus)

14

NIGHTS

10

PORTS

**Barcelona** ▶ Mallorca (Palma) ▶ Marseille (Provence) ▶ Corsica (Ajaccio) ▶ Genoa (for Cinque Terre) ▶ La Spezia (for Florence/Pisa) ▶ Civitavecchia (for Rome) ▶ Naples (for Capri & Pompeii) ▶ Crete (Chania) ▶ Kusadasi (for Ephesus) ▶ Mykonos **LATE NIGHT** ▶ **Athens (Piraeus)**

2026 DEPARTURES

Sun Princess

APR 4 SAT

APR 25<sup>2</sup> SAT

MAY 16<sup>2</sup> SAT

JUN 6 SAT

JUN 27 SAT

JUL 18<sup>2</sup> SAT

AUG 8<sup>3</sup> SAT

AUG 29 SAT

SEP 19<sup>2</sup> SAT

OCT 10<sup>2</sup> SAT

2027 DEPARTURES

Sun Princess

APR 11 SUN

MAY 2<sup>2</sup> SUN

MAY 23<sup>2</sup> SUN

AUG 15<sup>2</sup> SUN

SEP 5<sup>2</sup> SUN

SEP 26<sup>2</sup> SUN

OCT 17<sup>2</sup> SUN

<sup>2</sup>Cruise follows a different itinerary/order. <sup>3</sup>This is a Mediterranean with Total Solar Eclipse voyage and follows a different itinerary.

### The Best of the Mediterranean

Roundtrip Barcelona

21

NIGHTS

15

PORTS

**Barcelona** ▶ Mallorca (Palma) ▶ Marseille (Provence) ▶ Corsica (Ajaccio) ▶ Genoa (for Cinque Terre) ▶ La Spezia (for Florence/Pisa) ▶ Civitavecchia (for Rome) ▶ Naples (for Capri & Pompeii) ▶ Crete (Chania) ▶ Kusadasi (for Ephesus) ▶ Mykonos **LATE NIGHT** ▶ Athens (Piraeus) ▶ Santorini ↓ ▶ Bar ▶ Corfu ▶ Sicily (Messina) ▶ **Barcelona**

2026 DEPARTURES

Sun Princess

APR 4 SAT

APR 25<sup>5</sup> SAT

MAY 16<sup>5</sup> SAT

JUN 6 SAT

JUN 27 SAT

JUL 18<sup>5</sup> SAT

AUG 8<sup>4,5</sup> SAT

AUG 29 SAT

SEP 19<sup>5</sup> SAT

OCT 10<sup>5</sup> SAT

2027 DEPARTURES

Sun Princess

APR 11 SUN

MAY 2<sup>5</sup> SUN

MAY 23<sup>5</sup> SUN

AUG 15<sup>5</sup> SUN

SEP 5<sup>5</sup> SUN

SEP 26<sup>5</sup> SUN

OCT 17<sup>5</sup> SUN

<sup>4</sup>Total Solar Eclipse voyage. <sup>5</sup>Cruise follows a different order/itinerary.

Spanish Steps, Rome

### Mediterranean Marvel

Roundtrip Southampton

31

NIGHTS

20

PORTS

**Southampton** ▶ Guernsey (St. Peter Port) ↓ ▶ Seville (Cadiz) ▶ Malaga ▶ Cartagena ▶ Barcelona ▶ Toulon/Provence (La Seyne) ▶ Livorno (for Florence/Pisa) ▶ Civitavecchia (for Rome) ▶ Naples (for Capri & Pompeii) ▶ Istanbul **OVERNIGHT ONBOARD** ▶ Kusadasi (for Ephesus) **LATE NIGHT** ▶ Mykonos **LATE NIGHT** ▶ Athens (Piraeus) **LATE NIGHT** ▶ Santorini ↓ ▶ Crete (Chania) ▶ Katakolon (for Olympia) ▶ Sicily (Messina) ▶ Valletta **LATE NIGHT** ▶ Gibraltar ▶ Vigo (for Santiago de Compostela) ▶ **Southampton**

2027 DEPARTURE

Sky Princess

SEP 25 SAT

Blue Mosque, Istanbul

**MORE INFORMATION**  
Fleet information, deck plans, shore excursions and port timings can be found at [princess.com](https://princess.com). Full Booking Conditions can be found at [princess.com/legal](https://princess.com/legal)

**More Ashore** See the sights during the day and experience the nightlife after dark with Late Night (9 p.m. or later) or Overnight calls.

↓ Ship anchors offshore. Guests are transported ashore free of charge via water shuttle. Wheelchair access limited.

56 For prices & availability visit [princess.com](https://princess.com), or contact your travel advisor

57



# Alaska

We've been cruising here for over 50 years. Not only do we know Alaska, we LOVE it. So we give it our all. Port-packed itineraries. The best departures from Seattle. Top destinations, even ones that are hard to reach. Sail with us, and you'll love Alaska too.

📍 Star Princess, Alaska



# We love Alaska. So will you.



Glacier Bay National Park, Alaska

Our love affair is so strong that we're the #1 cruise line in Alaska. Explore everything from the majestic scenery of Glacier Bay National Park to our wilderness lodges at the doorstep of Denali and beyond. Choose from five departure ports, 7-20 night itineraries and eight ships including new Star Princess. Built for Alaska by the best in Alaska, you'll experience the same high-level hospitality, dining and entertainment, with extra-special details designed to surprise and delight.



## Authorised Concessioner

Princess Cruises is an authorised concessioner of Glacier Bay National Park. Princess is among the few cruise lines able to bring guests up close to this UNESCO World Heritage Site, as national park rangers climb aboard to share fascinating commentary and answer questions.



Savour local flavours and Alaska-themed cocktails and mocktails at the pop-up Crab Shack. Get to know local lumberjacks and a renowned dog musher. Inside the planetarium, discover ethereal experiences under the northern lights.



Cook My Catch, Alaska

## VOYAGE OF THE GLACIERS

Sail through the Inside Passage until you arrive in historic ports such as Ketchikan, Juneau and Skagway. Your heart will swell at the sight of tidewater glaciers in beautiful spots like Glacier Bay National Park, Hubbard Glacier or College Fjord.

*Sail roundtrip from Vancouver on a 14-night Voyage of the Glaciers Grand Adventure cruise that combines two 7-night sailings! Visit [princess.com](https://princess.com) for details.*



Mendenhall Glacier – Juneau, Alaska

### Southbound

*Anchorage (Whittier) to Vancouver*

7

NIGHTS

3

PORTS

2

GLACIERS



**Anchorage (Whittier)** ▶ Hubbard Glacier Scenic Cruising ▶ Glacier Bay National Park Scenic Cruising ▶ Skagway ▶ Juneau ▶ Ketchikan ▶ **Vancouver**

#### 2026 DEPARTURES

##### Island Princess

Fortnightly Wednesday departures from MAY 20 to SEP 9

##### Coral Princess

Fortnightly Wednesday departures from MAY 27 to SEP 2

##### Grand Princess

Fortnightly Saturday departures from MAY 23 to SEP 12

##### Discovery Princess<sup>1</sup>

Fortnightly Saturday departures from MAY 16 to SEP 5

#### 2027 DEPARTURES

##### Island Princess

Fortnightly Wednesday departures from MAY 19 to SEP 8

##### Coral Princess

Fortnightly Wednesday departures from MAY 26 to SEP 1

##### Crown Princess

Fortnightly Saturday departures from MAY 15 to SEP 4

##### Discovery Princess<sup>1</sup>

Fortnightly Saturday departures from MAY 22 TO SEP 11

<sup>1</sup>Discovery Princess cruises sail on the west side of Vancouver Island and Icy Strait Point replaces Skagway.

### Northbound

*Vancouver to Anchorage (Whittier)*

7

NIGHTS

3

PORTS

2

GLACIERS



**Vancouver** ▶ Ketchikan ▶ Juneau **LATE NIGHT** ▶ Skagway ▶ Glacier Bay National Park Scenic Cruising ▶ College Fjord Scenic Cruising ▶ **Anchorage (Whittier)**

#### 2026 DEPARTURES

##### Island Princess<sup>2,4</sup>

Fortnightly Wednesday departures from MAY 13 to SEP 2

##### Coral<sup>3</sup> Princess

Fortnightly Wednesday departures from MAY 20 to AUG 26

##### Grand Princess

Fortnightly Saturday departures from MAY 16 to SEP 5

##### Discovery Princess<sup>2</sup>

Fortnightly Saturday departures from MAY 9 to AUG 29

#### 2027 DEPARTURES

##### Island Princess

Fortnightly Wednesday departures from MAY 12 to SEP 1

##### Coral Princess

Fortnightly Wednesday departures from MAY 19 to AUG 25

##### Crown Princess

Fortnightly Saturday departures from MAY 8 to AUG 28

##### Discovery Princess<sup>2</sup>

Fortnightly Saturday departures from MAY 15 to SEP 4

<sup>2</sup>Discovery Princess cruises sail on the west side of Vancouver Island.  
<sup>3</sup>On selected cruises Hubbard Glacier Scenic Cruising replaces Glacier Bay National Park Scenic Cruising. <sup>4</sup>Selected cruises follow a different order and Icy Strait Point replaces Skagway.

#### MORE INFORMATION

Fleet information, deck plans, shore excursions and port timings can be found at [princess.com](https://princess.com). Full Booking Conditions can be found at [princess.com/legal](https://princess.com/legal)

#### More Ashore

See the sights during the day and experience the nightlife after dark with Late Night (9 p.m. or later) or Overnight calls.



Ship anchors offshore. Guests are transported ashore free of charge via water shuttle. Wheelchair access limited.



ROUNDRIP TO ALASKA’S INSIDE PASSAGE

The Inside Passage is your gateway to Alaska’s most stunning moments. Watch the scenery from an expansive deck, from your private balcony, or in a comfortable lounge as you glide past glaciers. Watch for wildlife and anticipate adventures ahead in Alaska’s most famous ports of call.

Inside Passage

7 NIGHTS4 PORTS1 GLACIER

Roundtrip Seattle



Seattle ▶ Ketchikan ▶ Endicott Arm and Dawes Glacier Scenic Cruising ▶ Juneau **LATE NIGHT** ▶ Skagway ▶ Victoria **LATE NIGHT** ▶ Seattle

2026 DEPARTURES

Star Princess

Weekly Sunday departures from MAY 3 to SEP 13

2027 DEPARTURES

Star Princess

Weekly Sunday departures from MAY 9 to SEP 19

Inside Passage with Glacier Bay National Park

7 NIGHTS4 PORTS1 GLACIER

Roundtrip Seattle



Seattle ▶ Juneau **LATE NIGHT** ▶ Skagway ▶ Glacier Bay National Park Scenic Cruising ▶ Ketchikan ▶ Victoria **LATE NIGHT** ▶ Seattle

2026 DEPARTURES

Royal Princess

Weekly Saturday departures from MAY 9 to SEP 12

2027 DEPARTURES

Royal Princess

Weekly Saturday departures from MAY 1 to SEP 4

Inside Passage

7 NIGHTS3 PORTS1 GLACIER

Roundtrip Vancouver



Vancouver ▶ Juneau **LATE NIGHT** ▶ Skagway ▶ Endicott Arm and Dawes Glacier Scenic Cruising ▶ Ketchikan ▶ Vancouver

2026 DEPARTURES

Emerald Princess

MAY 19 TUE, then weekly Tuesday departures from JUN 2 to AUG 25

Coral Princess

SEP 9<sup>\*</sup> WED SEP 16<sup>\*</sup> WED

Discovery Princess<sup>†</sup>

SEP 12<sup>\*</sup> SAT SEP 19<sup>\*</sup> SAT

2027 DEPARTURES

Emerald Princess

Weekly Tuesday departures from MAY 18 to AUG 31

Crown Princess

MAY 1<sup>\*</sup> SAT

Discovery Princess<sup>†</sup>

SEP 18<sup>\*</sup> SAT

<sup>†</sup>Discovery Princess cruises sail on the west side of Vancouver Island.  
<sup>\*</sup>Cruise follows a different order. <sup>\*</sup>Glacier Bay National Park Scenic Cruising replaces Endicott Arm and Dawes Glacier Scenic Cruising.

Inside Passage

10 NIGHTS4 PORTS1 GLACIER

Roundtrip San Francisco

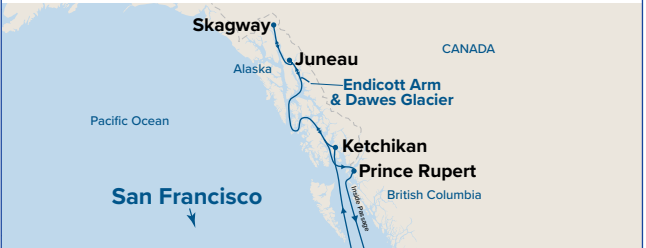

San Francisco ▶ Ketchikan ▶ Juneau **LATE NIGHT** ▶ Skagway ▶ Endicott Arm and Dawes Glacier Scenic Cruising ▶ Prince Rupert ▶ San Francisco

2026 DEPARTURES

Ruby Princess<sup>†</sup>

MAY 13 WED JUL 2 THU AUG 1 SAT AUG 31<sup>\*</sup> MON  
MAY 23 SAT JUL 12 SUN AUG 11<sup>\*</sup> TUE AUG 21 FRI  
JUN 2<sup>\*</sup> TUE JUL 22 WED

2027 DEPARTURES

Ruby Princess<sup>†</sup>

MAY 1 SAT JUN 10 THU JUL 20<sup>\*</sup> TUE AUG 29<sup>\*</sup> SUN  
MAY 11 TUE JUN 20<sup>\*</sup> SUN JUL 30<sup>\*</sup> FRI SEP 8 WED  
MAY 21<sup>\*</sup> FRI JUN 30<sup>\*</sup> WED AUG 9 MON  
MAY 31<sup>\*</sup> MON JUL 10<sup>\*</sup> SAT AUG 19 THU

<sup>\*</sup>Selected cruises follow a different itinerary/order. <sup>\*</sup>Cruise anchors offshore in Juneau and Prince Rupert; no late night in Juneau. <sup>\*</sup>Cruise anchors offshore in Prince Rupert. <sup>\*</sup>No late night in Juneau.

Inside Passage

11 NIGHTS5 PORTS2 GLACIERS

Roundtrip Vancouver



Vancouver ▶ Sitka ▶ Glacier Bay National Park Scenic Cruising ▶ Skagway ▶ Juneau ▶ Hubbard Glacier Scenic Cruising ▶ Icy Strait Point ▶ Ketchikan ▶ Vancouver

2026 DEPARTURE

Emerald Princess

MAY 8 FRI

Alaska						
NIGHTS	ITINERARY	PORTS	SHIP	2026	2027	
7	Inside Passage with Endicott Arm	Seattle ▶ Ketchikan ▶ Endicott Arm and Dawes Glacier Scenic Cruising ▶ Juneau <b>LATE NIGHT</b> ▶ Skagway ▶ Vancouver	Star Princess	SEP 20 SUN	SEP 26 SUN	
7	Inside Passage with Glacier Bay National Park	Vancouver ▶ Juneau <b>LATE NIGHT</b> ▶ Skagway ▶ Glacier Bay National Park Scenic Cruising ▶ Ketchikan ▶ Seattle	Royal Princess	MAY 2 SAT		
10	Inside Passage with Glacier Bay National Park	San Francisco ▶ Ketchikan ▶ Glacier Bay National Park Scenic Cruising ▶ Skagway ▶ Sitka ▶ Prince Rupert ▶ San Francisco	Ruby Princess	MAY 3 SUN		
10	Inside Passage with Glacier Bay National Park	Vancouver ▶ Sitka ▶ Glacier Bay National Park Scenic Cruising ▶ Skagway ▶ Juneau ▶ Icy Strait Point ▶ Ketchikan ▶ Victoria ▶ Vancouver	Grand Princess	MAY 6 WED		
16	Inside Passage with Glacier Bay National Park	Los Angeles ▶ Juneau <b>LATE NIGHT</b> ▶ Skagway ▶ Glacier Bay National Park Scenic Cruising ▶ Icy Strait Point ▶ Sitka ▶ Ketchikan ▶ Victoria ▶ Los Angeles	Emerald Princess	SEP 14 MON	APR 27 TUE SEP 18 SAT	
20	Ultimate Alaska Solstice with Glacier Bay National Park	San Francisco ▶ Ketchikan ▶ Wrangell ▶ Endicott Arm and Dawes Glacier Scenic Cruising ▶ Juneau ▶ Skagway ▶ Glacier Bay National Park Scenic Cruising ▶ Hubbard Glacier Scenic Cruising ▶ Valdez ▶ Anchorage (Seward) ▶ College Fjord Scenic Cruising ▶ Sitka ▶ Icy Strait Point ▶ Prince Rupert ▶ San Francisco	Ruby Princess	JUN 12 FRI		

MORE INFORMATION  
Fleet information, deck plans, shore excursions and port timings can be found at [princess.com](https://princess.com). Full Booking Conditions can be found at [princess.com/legal](https://princess.com/legal)

More Ashore See the sights during the day and experience the nightlife after dark with Late Night (9 p.m. or later) or Overnight calls.

Ship anchors offshore. Guests are transported ashore free of charge via water shuttle. Wheelchair access limited.

62 For prices and availability, visit [princess.com](https://princess.com) or contact your travel advisor

63



# Land and sea, a perfect pairing

Create a fully immersive experience by pairing a seven-night Voyage of the Glaciers cruise with a rail journey and overnight stays at Princess Wilderness Lodges. All cruisetours include at least one night in the Denali area and the choice to spend nights in Copper River, Wrangell-St. Elias National Park, the Kenai Peninsula and historic Fairbanks.

## Northbound cruisetour

cruise

Start with glaciers and frontier towns on a 7-night Voyage of the Glaciers cruise

+

train

Enjoy scenic travel via exclusive Princess Direct-to-the-Wilderness rail service

+

lodge

Spend three or more nights on land at Princess Wilderness Lodges

## Southbound cruisetour

lodge

Start with three or more nights on land at Princess Wilderness Lodges

+

train

Travel by exclusive Princess Direct-to-the-Wilderness rail service

+

cruise

End with a 7-night Voyage of the Glaciers cruise to see glaciers and frontier towns

Hiking, Denali National Park



### COPPER RIVER PRINCESS WILDERNESS LODGE

Forged between two rivers, right on the edge of Wrangell-St. Elias, Copper River Princess Wilderness Lodge offers unprecedented access to one of the most spectacular destinations in Alaska. Rise to spellbinding valley views before embarking on a ranger-led walking trail showcasing the national park's stunning flora and fauna.

### DENALI PRINCESS WILDERNESS LODGE

Set against a breathtaking backdrop, Denali Princess Wilderness Lodge perches on the outermost edge of Denali National Park, with sweeping vistas of the Nenana River. Dine with a panoramic view on the river-view deck, hike across pristine tundra, or take to the skies as you skim the tree tops and gain a fresh perspective on this epic landscape.

### KENAI PRINCESS WILDERNESS LODGE

Kenai Princess Wilderness Lodge is your ticket to Alaska's playground – the Kenai Peninsula. Spend your days sledding, canoeing, or fishing for wild salmon, before unwinding fireside with a freshly caught feast. Or simply ease back in utmost comfort and soak in the views from your private porch.

### MT. MCKINLEY PRINCESS WILDERNESS LODGE

A true wilderness retreat, our most popular lodge indulges guests with views of Denali, the tallest peak in North America. Wet your whistle with birch syrup-tasting parties in the trees, take to the river by raft, or gaze in awe at a photosymphonic aurora borealis show.





# Caribbean

Discover the beauty of the beaches in the Eastern Caribbean, marvel over Mayan ruins in the Western Caribbean and connect with local cultures in the Southern Caribbean. Convenient departures and a variety of itineraries mean that your dreams of paradise will come true just as soon as you decide that it's go time.



📍 Sun Princess, Caribbean



Eastern Caribbean

Eastern Caribbean  
with Puerto Rico

Roundtrip Fort Lauderdale

7  
NIGHTS

4  
PORTS

Fort Lauderdale ▶ Celebration Key ▶ Amber Cove ▶ San Juan ▶ Grand Turk ▶ Fort Lauderdale

2026 DEPARTURES

Sun Princess  
DEC 20<sup>1</sup> SUN

2027 DEPARTURES

Sun Princess  
FEB 28<sup>1</sup> SUN    NOV 27 SAT

Sky Princess  
NOV 21<sup>1</sup> SUN    DEC 12<sup>1</sup> SUN

Regal Princess  
APR 3 SAT

2028 DEPARTURES

Sky Princess  
JAN 2<sup>1</sup> SUN    JAN 23<sup>1</sup> SUN    FEB 13<sup>1</sup> SUN    MAR 5<sup>1</sup> SUN  
JAN 8 SAT    JAN 29 SAT    FEB 19 SAT

<sup>1</sup>Cruise follows a different itinerary/order.



Amber Cove, Caribbean

Eastern Caribbean  
with St. Thomas

Roundtrip Miami

7  
NIGHTS

3  
PORTS

Miami ▶ Princess Cays ↓ ▶ St. Thomas ▶ St. Maarten ▶ Miami

2027 DEPARTURE

Regal Princess  
DEC 5 SUN

2028 DEPARTURES

Regal Princess  
JAN 16 SUN    FEB 27 SUN    MAR 19 SUN    APR 9 SUN  
FEB 6 SUN

Eastern Caribbean  
with Turks & Caicos

Roundtrip Port Canaveral

7  
NIGHTS

4  
PORTS

Port Canaveral (Orlando) ▶ Nassau ▶ Princess Cays ↓ ▶ Amber Cove ▶ Grand Turk ▶ Port Canaveral (Orlando)

2026 DEPARTURES

Caribbean Princess  
MAY 17 SUN    JUL 19 SUN    SEP 20 SUN  
JUN 7 SUN    AUG 9 SUN    SEP 27 SUN  
JUN 28 SUN    AUG 30 SUN    OCT 11 SUN

Eastern Caribbean						
NIGHTS	ITINERARY	PORTS	SHIP	2026	2027	2028
8	Eastern Caribbean with Tortola	Miami ▶ Amber Cove ▶ San Juan ▶ St. Maarten ▶ Tortola ▶ Miami	Regal Princess		NOV 27 SAT DEC 19 SUN	
9	Eastern Caribbean with St. Thomas	Port Canaveral (Orlando) ▶ Grand Turk ▶ Amber Cove ▶ San Juan ▶ St. Maarten ▶ St. Thomas ▶ Port Canaveral (Orlando)	Star Princess		NOV 14 SUN	MAR 5 SUN MAR 29 <sup>6</sup> WED
10	Eastern Caribbean with St. Kitts	Fort Lauderdale ▶ Princess Cays ↓ ▶ Amber Cove ▶ San Juan ▶ St. Maarten ▶ Antigua ▶ St. Kitts ▶ Fort Lauderdale	Coral Princess Enchanted Princess	OCT 29 THU DEC 17 THU DEC 27 <sup>5</sup> SUN	JAN 6 <sup>2</sup> WED JAN 16 <sup>3</sup> SAT FEB 15 <sup>4</sup> MON MAR 17 <sup>5</sup> WED	
12	Eastern Caribbean Adventurer	Fort Lauderdale ▶ Princess Cays ↓ ▶ San Juan ▶ St. Thomas ▶ Fort Lauderdale ▶ Grand Turk ▶ Amber Cove ▶ Fort Lauderdale	Majestic Princess	MAR 22 SUN		
14	Eastern Caribbean Adventurer	Fort Lauderdale ▶ Celebration Key ▶ Grand Turk ▶ Nassau ▶ Fort Lauderdale ▶ St. Maarten ▶ San Juan ▶ Amber Cove ▶ Grand Turk ▶ Fort Lauderdale	Regal Princess	NOV 22 SUN NOV 28 <sup>7</sup> SAT	JAN 17 <sup>7</sup> SUN JAN 23 <sup>7</sup> SAT FEB 14 SUN FEB 20 <sup>7</sup> SAT	
14	Eastern Caribbean Adventurer	Miami ▶ St. Kitts ▶ San Juan ▶ Amber Cove ▶ Miami ▶ Princess Cays ↓ ▶ St. Thomas ▶ St Maarten ▶ Miami	Regal Princess			JAN 9 SUN JAN 30 SUN
14	Eastern Caribbean Adventurer	Miami ▶ Amber Cove ▶ San Juan LATE NIGHT ▶ Grand Turk ▶ Celebration Key ▶ Miami ▶ Princess Cays ↓ ▶ St. Thomas ▶ St. Maarten ▶ Miami	Regal Princess			FEB 20 SUN MAR 12 <sup>7</sup> SUN APR 2 <sup>7</sup> SUN
14	Eastern/Western Caribbean Adventurer	Fort Lauderdale ▶ Grand Turk ▶ San Juan ▶ Amber Cove ▶ Fort Lauderdale ▶ Celebration Key ▶ Roatan (Mahogany Bay) ▶ Cozumel ▶ Fort Lauderdale	Sun Princess Star Princess Regal Princess	NOV 22 <sup>7</sup> SUN NOV 29 <sup>7</sup> SUN DEC 6 <sup>7</sup> SUN DEC 13 <sup>7</sup> SUN MAR 7 <sup>7</sup> SAT MAR 14 <sup>7</sup> SAT APR 11 <sup>7</sup> SAT MAY 2 <sup>7</sup> SAT MAY 9 <sup>7</sup> SAT MAY 30 <sup>7</sup> SAT JUN 6 <sup>7</sup> SAT JUN 27 <sup>7</sup> SAT JUL 4 <sup>7</sup> SAT JUL 25 <sup>7</sup> SAT AUG 1 <sup>7</sup> SAT	JAN 3 SUN JAN 10 <sup>7</sup> SUN JAN 17 <sup>7</sup> SUN JAN 31 SUN FEB 7 <sup>7</sup> SUN FEB 14 <sup>7</sup> SUN FEB 21 <sup>7</sup> SUN FEB 28 <sup>7</sup> SUN MAR 7 <sup>7</sup> SUN NOV 27 <sup>7</sup> SAT	JAN 8 <sup>7</sup> SAT JAN 29 <sup>7</sup> SAT FEB 19 <sup>7</sup> 28
14	Eastern Caribbean Adventurer Holiday	Miami ▶ Amber Cove ▶ San Juan ▶ St. Maarten ▶ Tortola ▶ Miami ▶ Celebration Key ▶ Amber Cove ▶ Grand Turk ▶ Miami	Regal Princess		DEC 19 SUN	
15	Eastern Caribbean Adventurer	Miami ▶ Amber Cove ▶ San Juan ▶ St. Maarten ▶ Tortola ▶ Miami ▶ Princess Cays ↓ ▶ St. Thomas ▶ St. Maarten ▶ Miami	Regal Princess		NOV 27 SAT	

<sup>2</sup>Cruise follows a different order and calls at Celebration Key instead of Princess Cays. <sup>3</sup>Cruise calls at Celebration Key instead of Princess Cays. <sup>4</sup>Cruise operates in reverse and calls at Celebration Key instead of Princess Cays. <sup>5</sup>Cruise calls at Grand Turk instead of Princess Cays. <sup>6</sup>Cruise calls at Celebration Key instead of Grand Turk. <sup>7</sup>Cruise follows a slightly different itinerary/order.

MORE INFORMATION  
Fleet information, deck plans, shore excursions and port timings can be found at [princess.com](https://princess.com). Full Booking Conditions can be found at [princess.com/legal](https://princess.com/legal)

- More Ashore See the sights during the day and experience the nightlife after dark with Late Night (9 p.m. or later) or Overnight calls.
- Ship anchors offshore. Guests are transported ashore free of charge via water shuttle. Wheelchair access limited.



Western Caribbean



Private Bungalow, Princess Cays



Turquoise Bay, Roatán

Western Caribbean with Mexico

Roundtrip Fort Lauderdale

7

NIGHTS

3

PORTS

Fort Lauderdale ▶ Roatan (Mahogany Bay) ▶ Belize City ▶ Cozumel ▶ Fort Lauderdale

2026 DEPARTURES

Majestic Princess

MAR 15<sup>2</sup> SUN

Star Princess

MAR 7 SAT    OCT 24 SAT    NOV 21 SAT    DEC 5 SAT

MAR 21 SAT    NOV 7 SAT

Regal Princess

APR 18<sup>1</sup> SAT    JUN 13<sup>1</sup> SAT    AUG 8<sup>1</sup> SAT    OCT 3 SAT

MAY 2<sup>1</sup> SAT    JUN 27<sup>1</sup> SAT    AUG 22<sup>1</sup> SAT    OCT 24<sup>1</sup> SAT

MAY 16<sup>1</sup> SAT    JUL 11<sup>1</sup> SAT    SEP 5 SAT

MAY 30<sup>1</sup> SAT    JUL 25 SAT    SEP 19 SAT

Sun Princess

NOV 15<sup>2</sup> SUN    NOV 29<sup>2</sup> SUN    DEC 13<sup>2</sup> SUN    DEC 27<sup>1</sup> SUN

Star Princess

DEC 19<sup>1</sup> SAT

2027 DEPARTURES

Star Princess

JAN 2 SAT    JAN 30 SAT    FEB 27<sup>2</sup> SUN    MAR 27 SAT

JAN 16 SAT    FEB 13 SAT    MAR 13 SAT

Sun Princess

JAN 10<sup>2</sup> SUN    FEB 7<sup>2</sup> SUN    MAR 7<sup>2</sup> SUN    DEC 4<sup>2</sup> SAT

JAN 24<sup>1</sup> SUN    FEB 21<sup>2</sup> SUN    MAR 21<sup>1</sup> SUN

2028 DEPARTURES

Sun Princess

JAN 15<sup>2</sup> SAT    FEB 5<sup>2</sup> SAT    FEB 26<sup>2</sup> SAT

<sup>1</sup>Cruise operates in reverse. <sup>2</sup>Cruise follows a different itinerary.

Tulum Mayan Ruins, Cozumel

Western Caribbean with Grand Cayman Holiday

Roundtrip Fort Lauderdale

7

NIGHTS

4

PORTS

Fort Lauderdale ▶ Princess Cays ▶ Falmouth ▶ Grand Cayman ▶ Cozumel ▶ Fort Lauderdale

2027 DEPARTURES

Sky Princess

NOV 28 SUN    DEC 19 SUN

2028 DEPARTURES

Sky Princess

JAN 9 SUN    JAN 30 SUN    FEB 20 SUN

Western Caribbean with Mexico Holiday

Roundtrip Miami

7

NIGHTS

4

PORTS

Miami ▶ Belize City ▶ Roatan (Mahogany Bay) ▶ Cozumel ▶ Celebration Key ▶ Miami

2027 DEPARTURE

Regal Princess

NOV 20 SAT

Western Caribbean with Grand Cayman

Roundtrip Miami

7

NIGHTS

4

PORTS

Miami ▶ Celebration Key ▶ Falmouth ▶ Grand Cayman ▶ Cozumel ▶ Miami

2028 DEPARTURE

Regal Princess

MAR 5 SUN

Western Caribbean with Mexico

Roundtrip Galveston

7

NIGHTS

3

PORTS

Galveston ▶ Cozumel ▶ Roatan (Mahogany Bay) ▶ Costa Maya (Mahahual) ▶ Galveston

2026 DEPARTURES

Regal Princess

MAR 1 SUN    MAR 8<sup>3</sup> SUN    MAR 15<sup>3</sup> SUN

<sup>3</sup>Cruise follows a different order.

**MORE INFORMATION**  
Fleet information, deck plans, shore excursions and port timings can be found at [princess.com](https://princess.com). Full Booking Conditions can be found at [princess.com/legal](https://princess.com/legal)

**More Ashore** See the sights during the day and experience the nightlife after dark with Late Night (9 p.m. or later) or Overnight calls.

**Ship anchors offshore.** Guests are transported ashore free of charge via water shuttle. Wheelchair access limited.

70 For prices & availability visit [princess.com](https://princess.com), or contact your travel advisor

71



Southern Caribbean

Southern Caribbean with Barbados & St. Kitts

Roundtrip San Juan

7

NIGHTS

5

PORTS

San Juan ▶ St. Thomas ▶ St. Kitts ▶ Dominica ▶ Grenada ▶ Barbados ▶ San Juan

2026 DEPARTURE

Grand Princess

MAR 15<sup>1</sup> SUN

2027 DEPARTURES

Crown Princess

JAN 31 SUN    FEB 28 SUN

2028 DEPARTURE

Emerald Princess

JAN 23 SUN

<sup>1</sup>Cruise follows a different itinerary.

Southern Caribbean with Barbados & Antigua

Roundtrip San Juan

7

NIGHTS

5

PORTS

San Juan ▶ St. Thomas ▶ St. Maarten ▶ Antigua ▶ Dominica ▶ Barbados ▶ San Juan

2026 DEPARTURES

Grand Princess

MAR 1<sup>3</sup> SUN    MAR 8 SUN    MAR 22 SUN    MAR 29<sup>3</sup> SUN

2027 DEPARTURE

Crown Princess

FEB 7 SUN

<sup>3</sup>Cruise follows a different itinerary.

Southern Caribbean with Barbados Holiday

Roundtrip Fort Lauderdale

11

NIGHTS

7

PORTS

Fort Lauderdale ▶ Amber Cove ▶ San Juan ▶ St. Kitts ▶ St. Lucia ▶ Barbados ▶ Antigua ▶ St. Maarten ▶ Fort Lauderdale

2027 DEPARTURES

Enchanted Princess

DEC 24<sup>2</sup> FRI

Sun Princess

DEC 28 TUE

<sup>2</sup>Cruise follows a different itinerary.

Southern Caribbean Adventurer

Roundtrip San Juan

14

NIGHTS

11

PORTS

San Juan ▶ St. Thomas ▶ St. Maarten ▶ Antigua ▶ St. Lucia ▶ Barbados ▶ San Juan ▶ Tortola ▶ St. Kitts ▶ Dominica ▶ Grenada ▶ Barbados ▶ San Juan

2026 DEPARTURES

Grand Princess

MAR 1<sup>4</sup> SUN    MAR 15<sup>4</sup> SUN    MAR 22<sup>4</sup> SUN

Crown Princess

DEC 27<sup>4</sup> SUN

2027 DEPARTURES

Crown Princess

JAN 3<sup>4</sup> SUN    JAN 24<sup>4</sup> SUN    FEB 14<sup>4</sup> SUN    MAR 14<sup>4</sup> SUN

JAN 10<sup>4</sup> SUN    JAN 31<sup>4</sup> SUN    FEB 21<sup>4</sup> SUN

JAN 17<sup>4</sup> SUN    FEB 7<sup>4</sup> SUN    FEB 28<sup>4</sup> SUN

Grand Princess

MAR 7<sup>4</sup> SUN

Emerald Princess

NOV 21 SUN    DEC 5<sup>4</sup> SUN    DEC 19 SUN    DEC 26<sup>4</sup> SUN

NOV 28<sup>4</sup> SUN    DEC 12<sup>4</sup> SUN

2028 DEPARTURES

Emerald Princess

JAN 2 SUN    JAN 23<sup>4</sup> SUN    FEB 13<sup>4</sup> SUN    MAR 5<sup>4</sup> SUN

JAN 9<sup>4</sup> SUN    JAN 30 SUN    FEB 20<sup>4</sup> SUN    MAR 12 SUN

JAN 16<sup>4</sup> SUN    FEB 6<sup>4</sup> SUN    FEB 27 SUN

<sup>4</sup>Cruise follows a different order/itinerary.



Timothy Hill, St. Kitts



Willemstad, Curaçao

Southern Caribbean						
NIGHTS	ITINERARY	PORTS	SHIP	2026	2027	2028
8	Southern Caribbean with ABC Islands	Fort Lauderdale ▶ Curaçao <b>LATE NIGHT</b> ▶ Aruba <b>LATE NIGHT</b> ▶ Bonaire ▶ Fort Lauderdale	Regal Princess	APR 3 FRI DEC 12 <sup>5</sup> SAT	FEB 6 SAT MAR 6 <sup>5</sup> SAT	
			Caribbean Princess		DEC 14 <sup>6</sup> TUE NOV 23 <sup>6</sup> TUE	JAN 4 <sup>6</sup> TUE FEB 24 <sup>6</sup> THU APR 6 <sup>6</sup> THU
10	Southern Caribbean with Martinique	Fort Lauderdale ▶ Princess Cays ↓ ▶ San Juan ▶ St. Kitts ▶ St. Lucia ▶ Martinique ▶ Antigua ▶ Fort Lauderdale	Enchanted Princess	MAR 17 <sup>5</sup> TUE	DEC 5 <sup>6</sup> SUN	
			Caribbean Princess	APR 18 <sup>5</sup> SAT MAR 29 SUN		
			Coral Princess	DEC 26 <sup>5</sup> SAT		
10	Southern Caribbean with St. Lucia	Port Canaveral (Orlando) ▶ San Juan ▶ St. Kitts ▶ St. Lucia ▶ Antigua ▶ St. Thomas ▶ Port Canaveral (Orlando)	Sun Princess		DEC 18 <sup>5</sup> SAT	
			Star Princess		DEC 12 SUN	MAR 19 SUN
11	Southern Caribbean with Barbados	Fort Lauderdale ▶ St. Thomas ▶ St. Kitts ▶ St. Lucia ▶ Barbados ▶ Antigua ▶ St. Maarten ▶ Fort Lauderdale	Enchanted Princess			JAN 4 TUE JAN 25 TUE FEB 15 TUE
12	Southern Caribbean with Aruba	Fort Lauderdale ▶ Aruba <b>LATE NIGHT</b> ▶ Curaçao ▶ St. Lucia ▶ Barbados ▶ Dominica ▶ St. Maarten ▶ Fort Lauderdale	Island Princess	NOV 30 MON		
			Caribbean Princess	NOV 9 <sup>7</sup> FRI		
12	Southern Caribbean Islander	Galveston ▶ Cozumel ▶ Aruba <b>LATE NIGHT</b> ▶ Curaçao <b>LATE NIGHT</b> ▶ Antigua ▶ St. Maarten ▶ Fort Lauderdale	Regal Princess	MAR 22 SUN		
12	Southern Caribbean Islander	Port Canaveral (Orlando) ▶ Aruba <b>LATE NIGHT</b> ▶ Curaçao <b>LATE NIGHT</b> ▶ Bonaire ▶ Amber Cove ▶ Grand Turk ▶ Nassau ▶ Fort Lauderdale	Caribbean Princess	OCT 18 SUN		
14	Southern Caribbean Adventurer Holiday	Fort Lauderdale ▶ Falmouth ▶ Aruba <b>LATE NIGHT</b> ▶ Curaçao ▶ San Juan ▶ St. Thomas ▶ St. Maarten ▶ Antigua ▶ St. Lucia ▶ Barbados ▶ San Juan	Emerald Princess		NOV 14 SUN	
14	Southern Caribbean Adventurer Holiday	San Juan ▶ Barbados ▶ Grenada ▶ Dominica ▶ St. Kitts ▶ Tortola ▶ San Juan ▶ St. Thomas ▶ St. Maarten ▶ Antigua ▶ St. Lucia ▶ Barbados ▶ San Juan	Emerald Princess		DEC 12 SUN	

<sup>5</sup>Cruise follows a different itinerary. <sup>6</sup>Cruise is 9 nights, follows a different order and calls additionally at Grand Turk. <sup>7</sup>Cruise calls at Martinique instead of St. Lucia. <sup>8</sup>Cruise is 9 nights and follows a slightly different itinerary. <sup>9</sup>Cruise is 11 nights and follows a slightly different itinerary.

MORE INFORMATION

Fleet information, deck plans, shore excursions and port timings can be found at [princess.com](https://princess.com). Full Booking Conditions can be found at [princess.com/legal](https://princess.com/legal)

More Ashore

See the sights during the day and experience the nightlife after dark with Late Night (9 p.m. or later) or Overnight calls.

Ship anchors offshore

Ship anchors offshore. Guests are transported ashore free of charge via water shuttle. Wheelchair access limited.



# Panama Canal

Welcome to a modern world wonder. The Panama Canal's lock system is best experienced by a cruise ship, and Princess was the first passenger cruise line to transit the locks in 1967. Sail roundtrip from Fort Lauderdale or choose an ocean-to-ocean voyage between the Pacific and Atlantic oceans — transiting all three sets of locks and with excursions in the Caribbean and Central America.

📍 Aerial tram in Gamboa, Panama



Panama Canal

Panama Canal with  
Costa Rica & Caribbean

12  
NIGHTS

7  
PORTS

Roundtrip Fort Lauderdale

Fort Lauderdale ▶ Aruba **LATE NIGHT** ▶ Cartagena ▶ Panama Canal Partial Transit (New Locks) ▶ Colón ▶ Limón ▶ Grand Cayman ↕ ▶ Cozumel ▶ **Fort Lauderdale**

2027 DEPARTURES

Caribbean Princess

NOV 11 THU    DEC 23<sup>1</sup> THU

2028 DEPARTURES

Caribbean Princess

FEB 12 SAT    MAR 25 SAT

<sup>1</sup>Cruise does not visit Grand Cayman.

Panama Canal -  
Ocean to Ocean

16  
NIGHTS

7  
PORTS

Fort Lauderdale to Los Angeles

Fort Lauderdale ▶ Aruba ▶ Panama Canal Full Transit (New Locks) ▶ Fuerte Amador (for Panama City) ▶ Puntarenas ▶ Puerto Chiapas ▶ Huatulco ▶ Puerto Vallarta ▶ **Los Angeles**

2026 DEPARTURES

Grand Princess

APR 16 THU

Sapphire Princess

NOV 6 FRI

Island Princess

SEP 29<sup>6</sup> TUE  
DEC 12 SAT

2027 DEPARTURES

Island Princess

FEB 14<sup>6</sup> SUN    APR 19<sup>6</sup> MON  
MAR 18<sup>7</sup> THU    DEC 13<sup>8</sup> MON

2028 DEPARTURES

Island Princess

JAN 14<sup>6</sup> FRI    MAR 18<sup>5</sup> SAT  
FEB 15<sup>6</sup> TUE    APR 19<sup>5</sup> WED

<sup>5</sup>Cruise does not visit Aruba and transits the historic locks. <sup>6</sup>Cruise transits the historic locks. <sup>7</sup>Ensenada replaces Puerto Vallarta. <sup>8</sup>Cruise transits the historic locks, and Manzanillo replaces Puerto Vallarta.

Panama Canal -  
Ocean to Ocean

16  
NIGHTS

7  
PORTS

Los Angeles to Fort Lauderdale

Los Angeles ▶ Puerto Vallarta ▶ Huatulco ▶ Puerto Chiapas ▶ Puntarenas ▶ Fuerte Amador (for Panama City) **LATE NIGHT** ▶ Panama Canal Full Transit (Historic Locks) ▶ Aruba ▶ **Fort Lauderdale**

2026 DEPARTURES

Island Princess

SEP 20 SUN

Coral Princess

DEC 28 MON    SEP 29 TUE

Crown Princess

DEC 3<sup>4</sup> THU

2027 DEPARTURES

Island Princess

MAR 2 TUE    OCT 13<sup>2</sup> WED  
APR 3 SAT    DEC 29<sup>2</sup> WED

2028 DEPARTURES

Island Princess

JAN 30<sup>2</sup> SUN    MAR 2<sup>2</sup> THU    APR 3<sup>2</sup> MON

<sup>2</sup>Puerto Quetzal replaces Puerto Chiapas. <sup>3</sup>Cruise transits the new locks. <sup>4</sup>Cruise transits the new locks and Puerto Quetzal replaces Puerto Chiapas.

Panama Canal -  
Ocean to Ocean

16  
NIGHTS

7  
PORTS

Fort Lauderdale to San Diego

Fort Lauderdale ▶ Aruba ▶ Panama Canal Full Transit (Historic Locks) ▶ Fuerte Amador (for Panama City) ▶ Puntarenas ▶ Puerto Chiapas ▶ Huatulco ▶ Puerto Vallarta ▶ **San Diego**

2027 DEPARTURES

Island Princess

JAN 13 WED    JAN 29<sup>9</sup> FRI

<sup>9</sup>Cruise operates in reverse.

Coral Princess, Panama Canal

Sloth, Puntarenas

NIGHTS	ITINERARY	PORTS	SHIP	2026	2027	2028
15	Panama Canal - Ocean to Ocean	<b>Fort Lauderdale</b> ▶ Cartagena ▶ Panama Canal Full Transit (New Locks) ▶ Fuerte Amador (for Panama City) ▶ Puntarenas ▶ Puerto Chiapas ▶ Huatulco ▶ Puerto Vallarta ▶ <b>Los Angeles</b>	Coral Princess		JAN 6 WED	
16	Panama Canal - Ocean to Ocean	<b>Los Angeles</b> ▶ Cabo San Lucas ↕ ▶ Mazatlan ▶ Fuerte Amador (for Panama City) <b>LATE NIGHT</b> ▶ Panama Canal Full Transit (New Locks) ▶ Aruba ▶ <b>Fort Lauderdale</b>	Star Princess	OCT 4 SUN		
16	Panama Canal - Ocean to Ocean	<b>Los Angeles</b> ▶ Aruba ▶ Panama Canal Full Transit (New Locks) ▶ Fuerte Amador (for Panama City) ▶ Mazatlan ▶ Cabo San Lucas ↕ ▶ <b>Los Angeles</b>	Star Princess		APR 3 SAT	
16	Panama Canal - Ocean to Ocean	<b>Los Angeles</b> ▶ Cabo San Lucas ↕ ▶ Mazatlan ▶ Fuerte Amador (for Panama City) <b>LATE NIGHT</b> ▶ Panama Canal Full Transit (New Locks) ▶ Aruba ▶ <b>Port Canaveral (Orlando)</b>	Star Princess		OCT 10 SUN	
16	Panama Canal - Ocean to Ocean	<b>Port Canaveral (Orlando)</b> ▶ Celebration Key ▶ Aruba ▶ Panama Canal Full Transit (New Locks) ▶ Fuerte Amador (for Panama City) ▶ Mazatlan ▶ Cabo San Lucas ↕ ▶ <b>Los Angeles</b>	Star Princess			APR 7 FRI
18	Panama Canal - Ocean to Ocean	<b>Los Angeles</b> ▶ Puerto Vallarta ▶ Huatulco ▶ Puerto Quetzal ▶ Puntarenas ▶ Fuerte Amador (for Panama City) ▶ Panama Canal Full Transit (Historic Locks) ▶ Aruba ▶ <b>New York City (Manhattan or Brooklyn)</b>	Coral Princess		SEP 27 MON	
20	Panama Canal & Pacific Coast	<b>Vancouver</b> ▶ Los Angeles ▶ Puerto Vallarta ▶ Huatulco ▶ Puerto Quetzal ▶ Puntarenas ▶ Fuerte Amador (for Panama City) ▶ Panama Canal Full Transit (Historic Locks) ▶ Aruba ▶ <b>Fort Lauderdale</b>	Island Princess		OCT 9 SAT	
22	Panama Canal & Pacific Coast	<b>Vancouver</b> ▶ San Francisco ▶ San Diego ▶ Los Angeles ▶ Puerto Vallarta ▶ Huatulco ▶ Puerto Chiapas ▶ Puntarenas ▶ Fuerte Amador (for Panama City) <b>LATE NIGHT</b> ▶ Panama Canal Full Transit (Historic Locks) ▶ Aruba ▶ <b>Fort Lauderdale</b>	Coral Princess	SEP 23 WED		
23	Panama Canal & Pacific Coast	<b>Vancouver</b> <b>OVERNIGHT ONBOARD</b> ▶ Victoria ▶ San Francisco <b>OVERNIGHT ONBOARD</b> ▶ Los Angeles ▶ Cabo San Lucas ↕ ▶ Mazatlan ▶ Fuerte Amador (for Panama City) ▶ Panama Canal Full Transit (New Locks) ▶ Aruba ▶ <b>Fort Lauderdale</b>	Star Princess	SEP 27 SUN		
23	Panama Canal - Ocean to Ocean	<b>Fort Lauderdale</b> ▶ Cartagena ▶ Panama Canal Full Transit (Historic Locks) ▶ Fuerte Amador (for Panama City) ▶ Puntarenas ▶ Puerto Chiapas ▶ Huatulco ▶ Puerto Vallarta ▶ Los Angeles ▶ Hilo ▶ Kahului ▶ <b>Honolulu</b>	Coral Princess		JAN 6 WED	
23	Panama Canal & Pacific Coast	<b>Vancouver</b> ▶ San Diego ▶ Los Angeles ▶ Puerto Vallarta ▶ Huatulco ▶ Puerto Quetzal ▶ Puntarenas ▶ Fuerte Amador (for Panama City) ▶ Panama Canal Full Transit (Historic Locks) ▶ Aruba ▶ <b>New York City (Manhattan or Brooklyn)</b>	Coral Princess		SEP 22 WED	
23	Panama Canal & Pacific Coast	<b>Vancouver</b> ▶ Seattle ▶ San Francisco <b>OVERNIGHT ONBOARD</b> ▶ Los Angeles ▶ Cabo San Lucas ↕ ▶ Mazatlan ▶ Fuerte Amador (for Panama City) <b>LATE NIGHT</b> ▶ Panama Canal Full Transit (New Locks) ▶ Aruba ▶ <b>Port Canaveral (Orlando)</b>	Star Princess		OCT 3 SUN	

**MORE INFORMATION**  
Fleet information, deck plans, shore excursions and port timings can be found at [princess.com](https://princess.com). Full Booking Conditions can be found at [princess.com/legal](https://princess.com/legal)

More Ashore

See the sights during the day and experience the nightlife after dark with Late Night (9 p.m. or later) or Overnight calls.

Ship anchors offshore.

Guests are transported ashore free of charge via water shuttle. Wheelchair access limited.

76 For prices and availability, visit [princess.com](https://princess.com) or contact your travel advisor

77



# Japan

Discover the beauty of Japan. In 2027 Diamond Princess and Sapphire Princess sail the region for the first time. Experience a perfect blend of vibrant cities, sacred sites and natural wonders — from the energy of Tokyo to the breathtaking views of Mt. Fuji. Cruise Hokkaido's scenic shores, explore Kyoto's Golden Pavilion and uncover Osaka's hidden teahouses and fresh seafood. Every stop reveals a deeper side of Japan, rich in culture, charm and wonder.





Tachineputa Museum, Aomori

### Sea of Japan with Nebuta & Summer Festivals

Roundtrip Tokyo (Yokohama)

8

NIGHTS

4

PORTS

**Tokyo (Yokohama)** ▶ Nagasaki ▶ Busan ▶ Aomori (for Nebuta Festival) **LATE NIGHT** ▶ Hakodate (for Minato Festival) **LATE NIGHT** ▶ Tokyo (Yokohama)

2026 DEPARTURE

**Diamond Princess**  
JUL 28 TUE

2027 DEPARTURE

**Diamond Princess**  
JUL 28<sup>1</sup> WED

<sup>1</sup>Yatsushiro replaces Nagasaki.

### Hokkaido Spring Flowers

Roundtrip Tokyo (Yokohama)

10

NIGHTS

5

PORTS

**Tokyo (Yokohama)** ▶ Nagasaki ▶ Jeju (Seogwipo) ▶ Hakodate **LATE NIGHT** ▶ Muroran ▶ Aomori ▶ Tokyo (Yokohama)

2026 DEPARTURE

**Diamond Princess**  
APR 19 SUN

2027 DEPARTURES

**Diamond Princess**  
APR 20<sup>5</sup> TUE

**Sapphire Princess**  
APR 21<sup>6</sup> WED

<sup>5</sup>Cruise is 9 nights and operates in reverse order; Busan replaces Jeju (Seogwipo).  
<sup>6</sup>Cruise is 11 nights and follows a different itinerary.

### Japan Explorer Spring Flowers

Roundtrip Tokyo (Yokohama)

11

NIGHTS

9

PORTS

**Tokyo (Yokohama)** ▶ Kagoshima ▶ Nagasaki ▶ Busan ▶ Kanmon Straits Scenic Cruising ▶ Hiroshima ▶ Miyazaki (Aburatsu) ▶ Kochi ▶ Tokushima ▶ Shimizu (for Mt. Fuji) ▶ Tokyo (Yokohama)

2026 DEPARTURES

**Diamond Princess**  
MAR 17 TUE

**Diamond Princess**  
MAR 28<sup>7</sup> SAT

2027 DEPARTURE

**Sapphire Princess**  
MAR 6<sup>8</sup> SAT

<sup>7</sup>Cruise follows a different order; Matsuyama replaces Miyazaki; Kobe replaces Tokushima.  
<sup>8</sup>Cruise follows a different itinerary.

### Japan Explorer with Kumano Fireworks

Roundtrip Tokyo (Yokohama)

10

NIGHTS

7

PORTS

**Tokyo (Yokohama)** ▶ Kumano (for fireworks viewing) **LATE NIGHT** ▶ Wakayama ▶ Kochi ▶ Busan ▶ Nagasaki ▶ Kagoshima ▶ Shimizu (for Mt. Fuji) ▶ Tokyo (Yokohama)

2026 DEPARTURE

**Diamond Princess**  
AUG 16 SUN

2027 DEPARTURES

**Diamond Princess**  
AUG 16<sup>2</sup> MON

**Sapphire Princess**  
AUG 15<sup>3</sup> SUN

<sup>2</sup>Cruise follows a different itinerary. <sup>3</sup>Cruise is 13 nights and follows a different itinerary.

### Circle Japan with Nebuta & Summer Festivals

Roundtrip Tokyo (Yokohama)

11

NIGHTS

7

PORTS

**Tokyo (Yokohama)** ▶ Aomori (for Nebuta Festival) **LATE NIGHT** ▶ Sakaiminato ▶ Busan ▶ Kochi (for Yosakoi Festival) **LATE NIGHT** ▶ Tokushima (for Awa Odori Festival) **LATE NIGHT** ▶ Osaka (for Kyoto) ▶ Shimizu (for Mt. Fuji) ▶ Tokyo (Yokohama)

2026 DEPARTURE

**Diamond Princess**  
AUG 5 WED

2027 DEPARTURES

**Diamond Princess**  
AUG 5 THU

**Sapphire Princess**  
JUL 24<sup>4</sup> SAT  
AUG 4<sup>4</sup> WED

<sup>4</sup>Cruise follows a different itinerary.

### Circle Japan Spring Flowers

Roundtrip Tokyo (Yokohama)

11

NIGHTS

9

PORTS

**Tokyo (Yokohama)** ▶ Nagasaki ▶ Busan ▶ Sakaiminato ▶ Maizuru (for Kyoto) ▶ Kanazawa ▶ Sakata ▶ Hakodate ▶ Miyako ▶ Hitachinaka (for Nikko) ▶ Tokyo (Yokohama)

2026 DEPARTURE

**Diamond Princess**  
APR 8 WED

MORE INFORMATION

Fleet information, deck plans, shore excursions and port timings can be found at [princess.com](https://princess.com). Full Booking Conditions can be found at [princess.com/legal](https://princess.com/legal)

**More Ashore** See the sights during the day and experience the nightlife after dark with Late Night (9 p.m. or later) or Overnight calls.

Mt. Fuji, Shimzu

80 For prices & availability visit [princess.com](https://princess.com), or contact your travel advisor

81



Southern and Central Japan Cruises						
NIGHTS	ITINERARY	PORTS	SHIP	2026	2027	
7	Japan & Korea	<b>Tokyo (Yokohama)</b> ▶ Toba ⚓ ▶ Kochi ▶ Jeju (Seogwipo) ▶ Kagoshima ▶ <b>Tokyo (Yokohama)</b>	<b>Diamond Princess</b>  <b>Sapphire Princess</b>	JUL 21 TUE SEP 15 <sup>1</sup> TUE	JUL 21 <sup>1</sup> WED OCT 3 <sup>1</sup> SUN	MAY 29 SAT JUL 17 <sup>2</sup> SAT AUG 28 SAT
8	Sea of Japan	<b>Tokyo (Yokohama)</b> ▶ Nagasaki ▶ Busan ▶ Sakaiminato ▶ Aomori ▶ <b>Tokyo (Yokohama)</b>	<b>Diamond Princess</b>	JUN 6 SAT	JUN 6 SUN	
9	Japan Explorer	<b>Tokyo (Yokohama)</b> ▶ Toba ⚓ ▶ Osaka (for Kyoto) ▶ Nagasaki ▶ Busan ▶ Kochi ▶ Shimizu (for Mt. Fuji) ▶ <b>Tokyo (Yokohama)</b>	<b>Diamond Princess</b>		JUN 14 MON SEP 15 <sup>3</sup> WED	
9	Southern Islands	<b>Tokyo (Yokohama)</b> ▶ Taipei (Keelung) <b>OVERNIGHT ONBOARD</b> ▶ Ishigaki ▶ Okinawa ▶ <b>Tokyo (Yokohama)</b>	<b>Diamond Princess</b>	APR 29 WED JUN 23 TUE SEP 22 TUE	JUN 23 <sup>4</sup> WED	
<sup>1</sup> Cruise follows a different itinerary. <sup>2</sup> Cruise includes extra port; Kanmon Straits Scenic Cruising. <sup>3</sup> Cruise follows a different order. <sup>4</sup> Cruise follows a different itinerary and Hualien replaces the second day of the overnight in Taipei.						

Central Japan Cruises						
NIGHTS	ITINERARY	PORTS	SHIP	2026	2027	
10	Japan Explorer	<b>Tokyo (Yokohama)</b> ▶ Beppu ▶ Hiroshima ▶ <i>Kanmon Straits Scenic Cruising</i> ▶ Shimonoseki ▶ Busan ▶ Nagasaki ▶ Miyazaki (Aburatsu) ▶ Kochi ▶ Toba ⚓ ▶ <b>Tokyo (Yokohama)</b>	<b>Diamond Princess</b>  <b>Sapphire Princess</b>	MAR 6 <sup>6</sup> FRI	MAY 8 <sup>6</sup> SAT	MAY 18 <sup>7</sup> TUE JUL 7 <sup>6</sup> WED JUN 16 <sup>7</sup> WED SEP 4 <sup>6</sup> SAT
10	Circle Japan	<b>Tokyo (Yokohama)</b> ▶ Hakodate ▶ Niigata ▶ Busan ▶ Nagasaki ▶ Kagoshima ▶ Kochi ▶ Shimizu (for Mt. Fuji) ▶ <b>Tokyo (Yokohama)</b>	<b>Diamond Princess</b>  <b>Sapphire Princess</b>	MAY 18 MON SEP 5 SAT	MAY 18 TUE SEP 5 SUN OCT 10 SUN	JUN 5 <sup>6</sup> SAT JUN 27 <sup>6</sup> SUN
14	Grand Japan with Fall Foliage	<b>Tokyo (Yokohama)</b> ▶ Hakodate ▶ Aomori ▶ Akita ▶ Niigata ▶ Kanazawa ▶ Sakaiminato ▶ Busan ▶ Nagasaki ▶ Kagoshima ▶ Miyazaki (Aburatsu) ▶ Kochi ▶ Omaezaki ▶ <b>Tokyo (Yokohama)</b>	<b>Diamond Princess</b>	OCT 28 WED NOV 11 <sup>6</sup> WED	OCT 30 <sup>6</sup> SAT NOV 13 <sup>6</sup> SAT	
<sup>6</sup> Cruise follows a different itinerary. <sup>6</sup> Cruise follows a different itinerary; roundtrip from Port of Tokyo. <sup>7</sup> Cruise is 11 nights and follows a different itinerary; roundtrip from Port of Tokyo.						

Cherry Blossom Cruises						
NIGHTS	ITINERARY	PORTS	SHIP	2026	2027	
10	Japan Explorer Cherry Blossoms	<b>Tokyo</b> ▶ Toba ⚓ ▶ Wakayama ▶ Kochi ▶ Kagoshima ▶ Yatsushiro ▶ Busan ▶ <i>Kanmon Straits Scenic Cruising</i> ▶ Hiroshima ▶ <b>Tokyo</b>	<b>Sapphire Princess</b>		MAR 29 MON	
11	Japan Explorer Cherry Blossoms	<b>Tokyo (Yokohama)</b> ▶ Beppu ▶ Hiroshima <b>LATE NIGHT</b> ▶ <i>Kanmon Straits Scenic Cruising</i> ▶ Busan ▶ Nagasaki ▶ Miyazaki (Aburatsu) ▶ Kochi ▶ Kobe (for Kyoto) <b>LATE NIGHT</b> ▶ <b>Tokyo (Yokohama)</b>	<b>Diamond Princess</b>		MAR 16 TUE	
12	Japan Explorer Cherry Blossoms	<b>Tokyo</b> ▶ Nagoya ▶ Kobe (for Kyoto) <b>LATE NIGHT</b> ▶ Tokushima ▶ Kochi ▶ Nagasaki ▶ Busan ▶ <i>Kanmon Straits Scenic Cruising</i> ▶ Hiroshima <b>LATE NIGHT</b> ▶ Beppu ▶ <b>Tokyo</b>	<b>Sapphire Princess</b>		MAR 17 WED	
			<b>Diamond Princess</b>		MAR 27 <sup>8</sup> SAT	
13	Circle Japan Cherry Blossoms	<b>Tokyo</b> ▶ Miyako ▶ Hakodate <b>LATE NIGHT</b> ▶ Aomori ▶ Akita ▶ Niigata ▶ Kanazawa ▶ Sakaiminato ▶ Busan ▶ Nagasaki ▶ Shimizu (for Mt. Fuji) ▶ <b>Tokyo</b>	<b>Sapphire Princess</b>		APR 8 THU	
			<b>Diamond Princess</b>		APR 8 <sup>9</sup> THU	
<sup>8</sup> Cruise follows a different itinerary; roundtrip from Tokyo (Yokohama). <sup>9</sup> Cruise is 12 nights and follows a different itinerary; roundtrip from Tokyo (Yokohama).						

### Japan Explorer

Roundtrip Tokyo (Yokohama)

9

NIGHTS

7

PORTS

**Tokyo (Yokohama)** ▶ Nagasaki ▶ Busan ▶ *Kanmon Straits Scenic Cruising* ▶ Hiroshima ▶ Kochi ▶ Kobe (for Kyoto) ▶ Shimizu (for Mt. Fuji) ▶ **Tokyo (Yokohama)**

2026 DEPARTURES

**Diamond Princess**

MAY 28<sup>10</sup> THU   JUN 14 SUN   OCT 1<sup>11</sup> THU   OCT 19<sup>12</sup> MON

<sup>10</sup>Cruise follows a different itinerary. <sup>11</sup>Cruise operates in reverse; Osaka replaces Kobe; Toba replaces Shimizu (for Mt. Fuji). <sup>12</sup>Miyazaki (Aburatsu) replaces Kochi; Tokushima replaces Kobe.

### Japan Explorer

Roundtrip Tokyo (Yokohama)

10

NIGHTS

8

PORTS

**Tokyo (Yokohama)** ▶ Toba ⚓ ▶ Osaka (for Kyoto) ▶ Kochi ▶ Hiroshima ▶ *Kanmon Straits Scenic Cruising* ▶ Busan ▶ Nagasaki ▶ Shimizu (for Mt. Fuji) ▶ **Tokyo (Yokohama)**

2026 DEPARTURES

**Diamond Princess**

MAY 8<sup>16</sup> FRI   JUL 11 SAT   AUG 26 WED

2027 DEPARTURES

**Diamond Princess**

JUL 11<sup>17</sup> SUN   AUG 26 THU   OCT 20<sup>17</sup> WED

<sup>16</sup>Cruise excludes Kochi. <sup>17</sup>Late night in Hiroshima.

### Circle Japan

Roundtrip Tokyo (Yokohama)

9

NIGHTS

6

PORTS

**Tokyo (Yokohama)** ▶ Nagasaki ▶ Busan ▶ Sakaiminato ▶ Tsuruga ▶ Toyama (Fushiki) ▶ Akita ▶ **Tokyo (Yokohama)**

2026 DEPARTURES

**Diamond Princess**

JUL 2 THU   OCT 10<sup>13</sup> SAT

2027 DEPARTURES

**Diamond Princess**

JUL 2<sup>14</sup> FRI

**Sapphire Princess**

MAY 9<sup>15</sup> SUN

<sup>13</sup>Cruise operates in reverse. <sup>14</sup>Cruise follows a different itinerary. <sup>15</sup>Cruise follows a different itinerary; roundtrip from Port of Tokyo.



📍 Castle, Osaka



# Important information

For your peace of mind

## Have a question?

Our cruises include an array of new destinations and experiences so it's only natural to have a question or two.

Whether you're completely new to cruising or just to Princess Cruises, or whether you have cruised with us before, our frequently asked questions at [princess.com/faq](https://princess.com/faq) is a fantastic resource.

You will find answers to the most popular questions we're asked about preparing for your cruise, your onboard experience and post-cruise disembarkation. Log on to [princess.com/faq](https://princess.com/faq) to discover a wealth of information including details about dining, keeping in touch whilst away and entertainment on board.

## FARES

**For up to date fares, please visit [princess.com](https://princess.com), call us on 0344 338 8671 or contact your Travel Advisor.**

## BOOKING CONDITIONS

Your Princess holiday is subject to our Booking Conditions which you can view by visiting [princess.com/passagetravel](https://princess.com/passagetravel) or by scanning the QR code. Please read the Booking Conditions carefully as they set out the terms of the contract relating to important issues such as your medical condition (clauses 18 to 24), cancellation (clauses 38 to 44), matters of security and safety (clauses 45 to 50), Princess' liability (clauses 52 to 65) and your right to claim (clauses 66 to 68). Please ensure that you take out travel insurance before you travel to cover you for any medical care you may need.



## FINANCIAL PROTECTION

The combination of travel services offered to you by Princess Cruises is a package within the meaning of the Package Travel and Linked Travel Arrangements Regulations 2018. Therefore, you will benefit from all UK rights applying to packages. Princess Cruises will be fully responsible for the proper performance of the package as a whole. Additionally, as required by law, Princess Cruises has protection in place to refund your payments and, where transport is included in the package, to ensure your repatriation if it becomes insolvent.

Please visit our website [www.princess.com](https://www.princess.com) for more information on key rights under the Package Travel and Linked Travel Arrangements Regulations 2018. If you are not able to access our website, you can ask us to send you a copy of these key rights. You can view a copy of the Package Travel and Linked Travel Arrangements Regulations 2018 at <https://www.legislation.gov.uk/uksi/2018/634/body>.

The fly cruises in this brochure are financially protected by the ATOL scheme. Our ATOL number is 6294. When you pay you will be supplied with an ATOL Certificate. Please ask for it and check to ensure that everything you booked (flights, hotels, and other services) is listed on it. ATOL protection does not apply to all holiday and travel services listed in this brochure. All non fly cruises sold in the UK are protected by ABTA. Please ask us to confirm what protection may apply to your booking. If you do not receive an ATOL Certificate, then the booking will not be ATOL protected. If you do receive an ATOL Certificate but all the parts of your trip are not listed on it, those parts will not be ATOL protected. Please see our Booking Conditions for further information, or for more information about financial protection and the ATOL Certificate go to: [www.atol.org](https://www.atol.org)

## ABTA MEMBERSHIP

We are a member of ABTA (membership number V8764) which means you have the benefit of ABTA's assistance and Code of Conduct. You can use ABTA's approved Alternative Dispute Resolution (ADR) process if you have a complaint that is not resolved. For more information, please see [www.abta.com](https://www.abta.com).

## DATA PROTECTION

Princess Cruises will process personal information about you in accordance with our Privacy Notice which is set out in our Booking Conditions and on our website at [princess.com/legal](https://princess.com/legal). This is correct at time of print however our most current Privacy Notice is available from our website.

We will use personal information about you to inform you about our products and services and deliver those products and services for you and will obtain your consent prior to doing so where required. Where necessary, we will share personal information about you with other Carnival group companies and our suppliers, sub-contractors, or other commercial partners, including those outside of the United Kingdom and the European Union, and we will use appropriate legal and technical safeguards when we do so. We retain personal information about you for no longer than necessary for the purpose of processing. Where you have provided consent, you may withdraw this at any time. You have limited rights to obtain, correct, or erase personal information about you, and to restrict or object to processing.

For more information or to complain about our processing of personal data contact us at: Data Protection Officer, Princess Cruises, Carnival House, 100 Harbour Parade, Southampton SO15 1ST or by email at [privacyPCL@princesscruises.com](mailto:privacyPCL@princesscruises.com). If you are not satisfied with our response, you have the right to submit a complaint to a relevant supervisory authority.

## BROCHURE INFORMATION

The information in this brochure represents our plans and intentions at the time of going to press. Events after the printing of this brochure may cause us to unavoidably change our plans, which could affect the published itineraries, prices, flights, and shore excursions. In the event of any significant changes or alterations to your booking, you will be told as soon as reasonably possible, but Princess Cruises gives notice that all information in this brochure is subject to alteration with or without notice. The photography used throughout this brochure depicts typical locations and scenes that may be viewed on a Princess cruise. Any imagery used may not be a specific representation of what can be seen on that cruise but may simply reflect the ambience or theme of a location visited. Example shore excursion shown within this brochure are typical for the destination but are subject to change. We can provide core information about our cruises in alternative formats. If you would like to discuss your requirements, please call our Reservations Team on 0344 338 8671 (local call charges apply).

## FLIGHTS AND TRANSFERS

Princess offers a variety of flight options to purchase with your cruise, depending on your chosen itinerary and personal preferences. Flights will automatically be assigned to your booking once we are within the 330 days. Flights can be assigned to any airline and any route and will be based on an economy basis only. If you book your cruise within 330 days before the return date, our innovative Plane Sailing programme is designed to seamlessly coordinate your air travel with your cruise itinerary. Once you have booked your cruise, go to 'Manage Booking' at [princess.com](https://princess.com) to view up to the minute flight schedules, with competitive, real time fares and inventory for only those flights that complement your cruise. Please call our Reservations Team, or your travel agent for more information. All flights are subject to availability. Where flight times require an overnight stay in the port of embarkation/disembarkation, you can book a hotel with Princess. We can help you upgrade your flight or extend your holiday; just call us to talk through your plans. Alternatively, you may wish to arrange your own flights, so please let us know at the time of booking.

## SPECIAL OFFERS FOR YOU

Sign up or manage your preference to receive our latest news and offers - already registered? Simply log in at [princess.com](https://princess.com) and update your preferences to ensure you receive our latest news and offers. If you've not yet signed up, register at [princess.com/signup](https://princess.com/signup) and be the first to hear about Princess deals.





# Drive, fly, arrive...

## FROM LAND AND AIR TO SEA, WE MAKE TRANSPORT SIMPLE

### CAR PARKING IN SOUTHAMPTON

Sail from Southampton knowing your vehicle will be safe and secure in the long-stay car park at the cruise terminals. To find out more and book, call Southampton Cruise & Passenger Services on **0345 071 3939** or visit **cruiseparking.co.uk**.

### COACH TRANSFERS TO SOUTHAMPTON

Begin and end your journey the more relaxing way with a return coach transfer from various pick-up points around the UK. Coach transfers are available with Sky Princess cruises sailing from Southampton in 2026 on cruises Y612 to Y631 and in 2027 on cruises Y712 to Y729. For details of Cruise Connect services, please call InterCruises on **0131 297 4391** or visit **intercruises.com/cruiseconnect**, quoting your six-digit cruise booking reference.

### HOTELS

Extend your holiday with a hotel stay before or after your cruise. Princess offers great value hotel packages, and all our hotels are carefully selected for excellent service, prime locations, and proximity to major attractions.

### SPECIAL OFFERS FOR YOU

Sign up or manage your preferences to receive our latest news and offers - already registered? Simply log in at **princess.com** and update your preferences to ensure you receive our latest news and offers. If you've not yet signed up, register at **princess.com/signup** and be the first to hear about Princess deals.

**COACH TRANSFERS** Please note your contract will be with the Cruise Connect operator, InterCruises. Pick up points may not necessarily be central to the city/town indicated. Coaches can be booked 72 hours after booking confirmation until 28 days prior to departure, and thereafter subject to availability. Where there are insufficient numbers to operate a route, InterCruises reserve the right to cancel that route no less than 28 days before departure.

### REGIONAL AND INTERNATIONAL FLIGHTS

Enjoy the convenience and cost savings you get from reserving your flights with Princess. Simply choose from two different pricing options – all are competitively priced, simple to book, and fully protected for complete peace of mind. We also offer a variety of regional flights into Southampton, to purchase with your fly cruise. To purchase flights after your cruise is booked, visit 'Manage Booking' at **princess.com**.

### AIRPORT TRANSFERS TO YOUR SHIP

Whether you book your flights through Princess or independently, you can still purchase a Princess airport-to-ship transfer. One of our representatives will meet you at the embarkation port airport where you'll then be transferred to your ship or hotel. If you haven't bought your air travel from Princess, you must provide us with flight details before you buy your transfer. For more details call **0344 338 8671** or visit Manage Booking at **princess.com**.

# Meet the Princess® fleet

Our 17 ships are a world unto themselves with amenities that range from main dining rooms and pools to casino, theater and lounges. Our entire fleet also offers the MedallionClass experience, including fast, reliable MedallionNet Wi-Fi.

## SIGNATURE FEATURES INCLUDE<sup>5</sup>:

	Star Princess*		Sun Princess*		Discovery Princess*		Enchanted Princess*		Sky Princess*		Majestic Princess*		Regal Princess*		Royal Princess*		Caribbean Princess*		Crown Princess*		Emerald Princess*		Ruby Princess*		Diamond Princess*		Sapphire Princess*		Grand Princess*		Coral Princess*		Island Princess*		
Guests	4,300		3,660				3,560				3,140		3,080				2,710	2,670	2,600	2,000	2,200														
Balconies	Over 1,500	Over 1,500	Over 1,400				Over 1,400				Over 800	Over 800				Over 700		Over 700	Over 700	Over 700	Over 700														
Movies Under the Stars® (poolside theatre)	✓	✓	✓	✓	✓	✓	✓	✓	✓	✓	✓	✓	✓	✓	✓	✓	✓	✓	✓	✓	✓	✓	✓	✓	✓	✓	✓	✓	✓	✓	✓	✓	✓	✓	
The Sanctuary (relaxing retreat for adults)			✓	✓	✓		✓	✓	✓	✓	✓	✓	✓	✓	✓	✓	✓	✓	✓	✓	✓	✓	✓	✓	✓	✓	✓	✓	✓	✓	✓	✓	✓	✓	
Italian-inspired Piazza	✓	✓	✓	✓	✓	✓	✓	✓	✓	✓	✓	✓	✓	✓	✓	✓	✓	✓	✓	✓	✓	✓	✓	✓	✓	✓	✓	✓	✓	✓	✓	✓	✓	✓	
International Café (24-hour coffees, desserts, sandwiches and tapas)	✓	✓	✓	✓	✓	✓	✓	✓	✓	✓	✓	✓	✓	✓	✓	✓	✓	✓	✓	✓	✓	✓	✓	✓	✓	✓	✓	✓	✓	✓	✓	✓	✓	✓	
Experiential Dining																																			
Chef's Table/Chef's Table Lumiere	✓	✓	✓	✓	✓	✓	✓	✓	✓	✓	✓	✓	✓	✓	✓	✓	✓	✓	✓	✓	✓	✓	✓	✓	✓	✓	✓	✓	✓	✓	✓	✓	✓	✓	
360: An Extraordinary Experience			✓	✓																															
Caymus Winemaker's Dinner	✓	✓	✓	✓	✓	✓	✓	✓	✓	✓	✓	✓	✓	✓	✓	✓	✓	✓	✓	✓	✓	✓	✓	✓	✓	✓	✓	✓	✓	✓	✓	✓	✓	✓	
Specialty Dining																																			
Sabatini's Italian Trattoria	✓	✓	✓	✓	✓	✓	✓	✓	✓	✓	✓	✓	✓	✓	✓	✓	✓	✓	✓	✓	✓	✓	✓	✓	✓	✓	✓	✓	✓	✓	✓	✓	✓	✓	
Crown Grill (steak & seafood)	✓	✓	✓	✓	✓	✓	✓	✓	✓	✓	✓	✓	✓	✓	✓	✓	✓	✓	✓	✓	✓	✓	✓	✓	✓	✓	✓	✓	✓	✓	✓	✓	✓	✓	
Love by Britto	✓	✓																																	
Churrascaria (Brazilian Grill)																							✓	✓											
Makoto Ocean/Kai Sushi by Makoto (sushi)	✓	✓																				✓	✓												
Umai Teppanyaki & Hot Pot	✓	✓																																	
The Catch by Rudi	✓	✓	✓	✓	✓	✓																													
The Butcher's Block by Dario	✓	✓																																	
Casual Dining																																			
Alfredo's/Gigi Pizzeria by Alfredo/Prego/Slice	✓	✓	✓	✓	✓	✓	✓	✓	✓	✓	✓	✓	✓	✓	✓	✓	✓	✓	✓	✓	✓	✓	✓	✓	✓	✓	✓	✓	✓	✓	✓	✓	✓	✓	
The Salty Dog Gastropub																✓			✓				✓			✓	✓	✓	✓	✓	✓	✓	✓	✓	
O'Malley's Irish Pub	✓	✓	✓	✓		✓												✓																	
Kai Sushi																						✓													

<sup>5</sup>Venues and dining options vary by ship and are subject to change. Nominal charges and service fees may apply. See deck plans on **princess.com/ships** for the most current information.





## HOW TO BOOK

Visit **PRINCESS.COM**

Call **0344 338 8671 (UK) 353 1800 939 608 (Ireland)**

CONTACT CENTRE OPENING HOURS MON-FRI 08:00-20:00. SAT 09:00-17:00. SUN & BANK HOLIDAY 10:00-16:00.

Contact your **TRAVEL ADVISOR**



Calls are charged at local rate plus your telephone company's network access charge.  
Princess Cruises, Carnival House, 100 Harbour Parade, Southampton SO15 1ST

All information contained within this brochure is correct at time of going to print in January 2026.

