

# DAWN PRINCESS®

The views are always unforgettable from the decks of the stunning Dawn Princess®. This spectacular ship features more than 400 affordable balcony staterooms — the best way to enjoy the majestic scenery. You'll be dazzled by the duty-free boutiques, art gallery, Grand Casino, Vista Show Lounge and other entertainment and activity offerings. And when it's time to dine, you can choose from casual options like La Scala pizzeria or Balcony Grill to elegant Traditional or Anytime Dining<sup>SM</sup> or the delectable delights in Sterling Steakhouse. It's a floating world truly dedicated to your every pleasure.

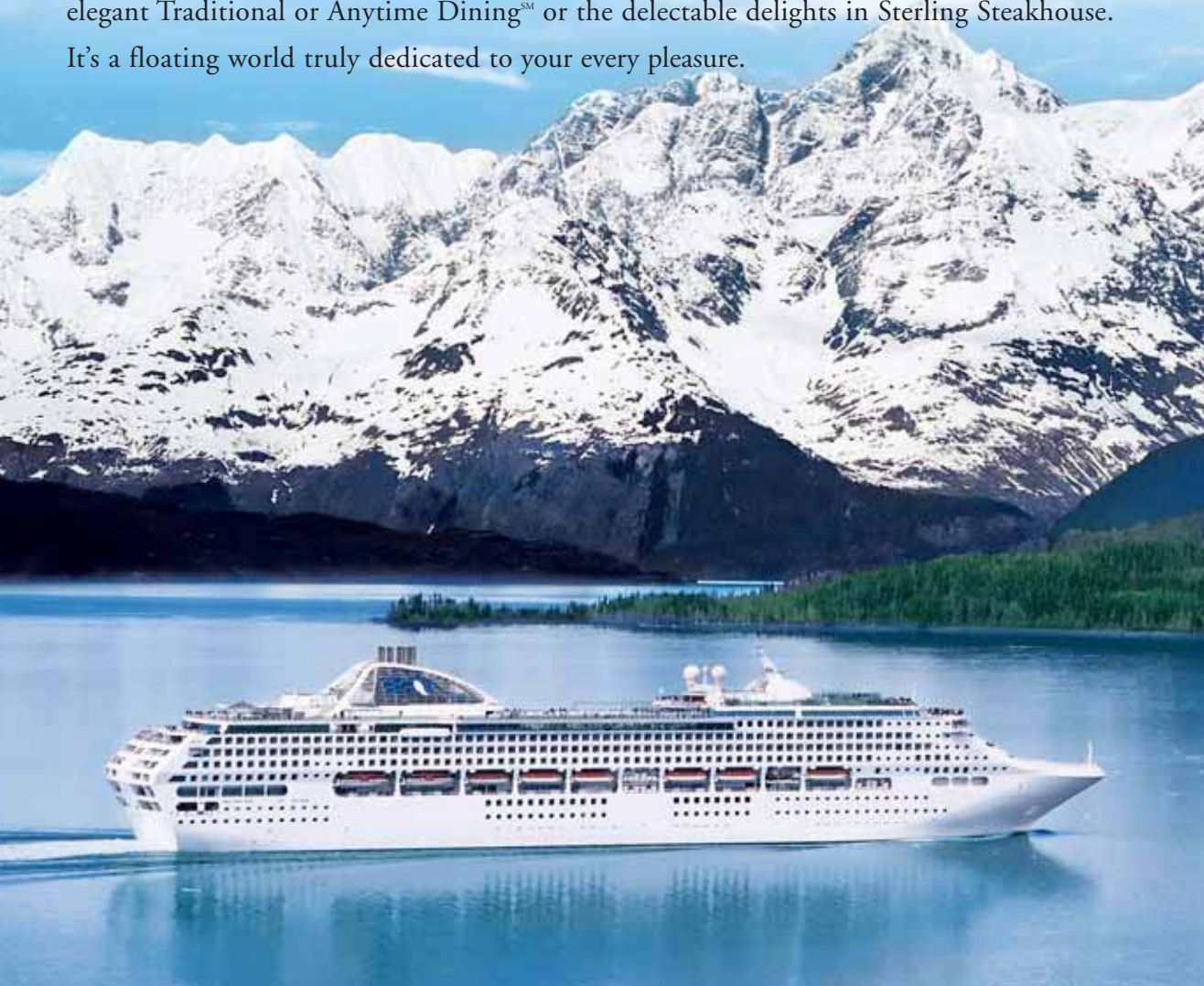

		DECK	
SHIP FACTS		<ul style="list-style-type: none"> <li>• Accommodates 1,990 passengers</li> <li>• Over 400 balcony staterooms</li> <li>• Wrap-around Promenade Deck</li> <li>• 857 feet in length</li> <li>• 77,000 gross tons</li> <li>• Bermudan registered</li> </ul>	
	PERSONAL CHOICE DINING®	TRADITIONAL	6 • Venetian Dining Room
		ANYTIME	5 • Florentine Dining Room
		SPECIALTY	14 • Sterling Steakhouse at Horizon Court
			- • Ultimate Balcony Dining
CASUAL		5 • Patisserie	
		7 • Wine bar	
		8 • La Scala (pizzeria)	
	12 • Sundaes ice cream bar		
	14 • Balcony Grill (burgers and hot dogs)		
	14 • 24-hour dining in the Horizon Court		
† • Afternoon tea			
- • 24-hour room service			
ENTERTAINMENT	THEATERS	7 • Princess Theater	
		7 • Vista Show Lounge	
	HOT SPOTS	8 • Grand Casino	
	LOUNGES & BARS	7 • Atrium Lounge & Bar	
		7 • Wheelhouse Bar	
		7 • Magnums	
		7 • Jammers	
ACTIVITIES	POOLS	12 • Lotus Spa® Pool (includes 2 hot tubs)	
		12 • Riviera Pool (includes 2 hot tubs)	
	SPORTS & SPA	12 • Lotus Spa®, gym and fitness area	
		12 • Digital golf simulators	
		14 • Shuffleboard	
	ENRICHMENT	15 • Sports Court	
		7 • 24-hour Internet Café (wireless access available)	
		7 • Library and writing room	
		12 • Card room	
	† • World-class art collection, gallery and auctions		
† • ScholarShip@Sea®			
SHOPPING	6 • Boutiques (duty-free)		
	7 • Photo Gallery		
	7 • Future Cruise Sales		
UNDER 18	KIDS & TEENS	12 • Teen Center	
		12 • Youth Center	
		15 • Splash pool	

† Location may vary.

# DAWN PRINCESS DECK PLANS

- SUN - 15
- LIDO - 14
- RIVIERA - 12
- ALOHA - 11
- BAJA - 10
- CARIBE - 9
- DOLPHIN - 8
- PROMENADE - 7
- EMERALD - 6
- PLAZA - 5
- FIESTA - 4

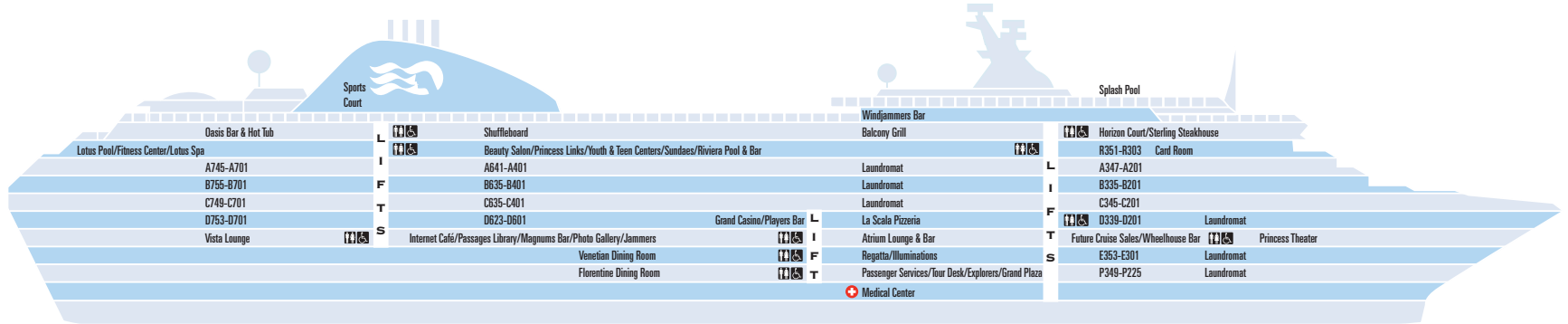

← AFT

## Sun 15

FORWARD →



## Lido 14

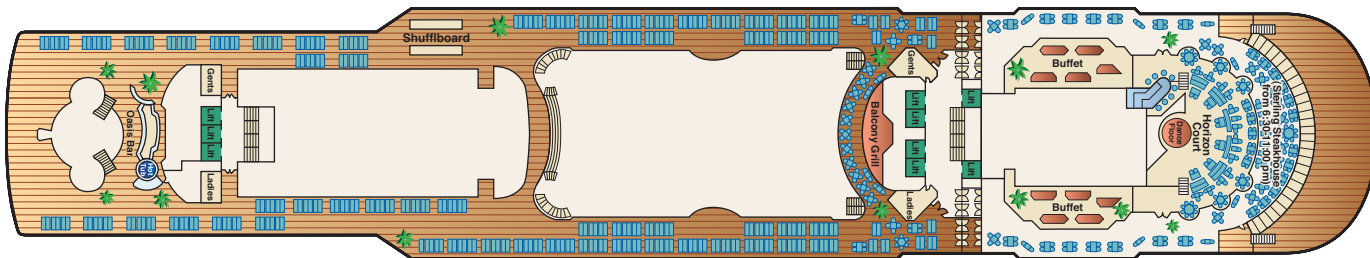

## Riviera 12

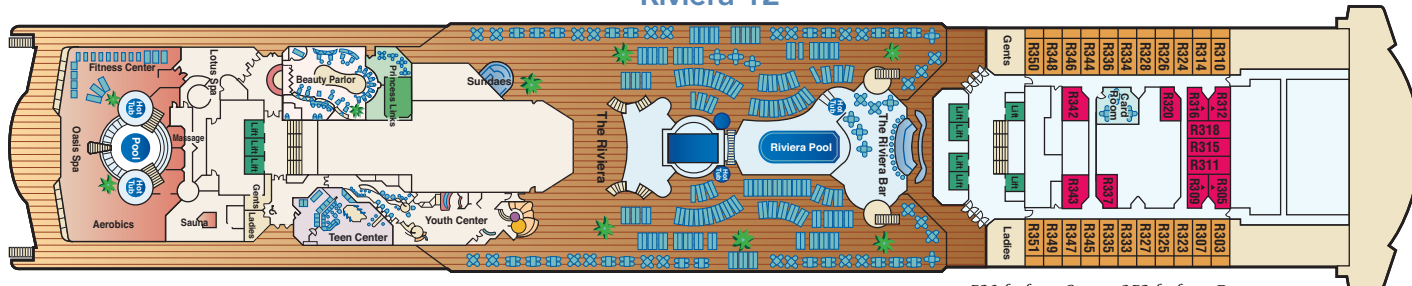

530 ft. from Stern 253 ft. from Bow

Distances shown are from the bow (forward) or stern (aft) to the nearest stateroom.

DAWN PRINCESS DECK PLANS

← AFT

FORWARD →

Aloha 11

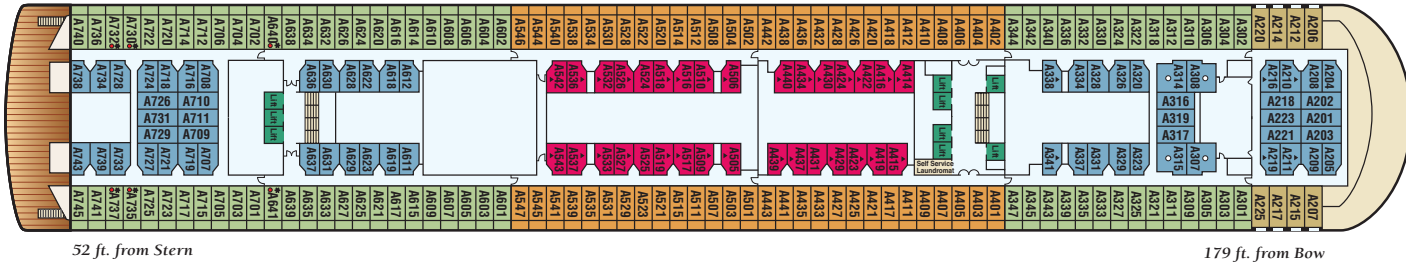

Baja 10

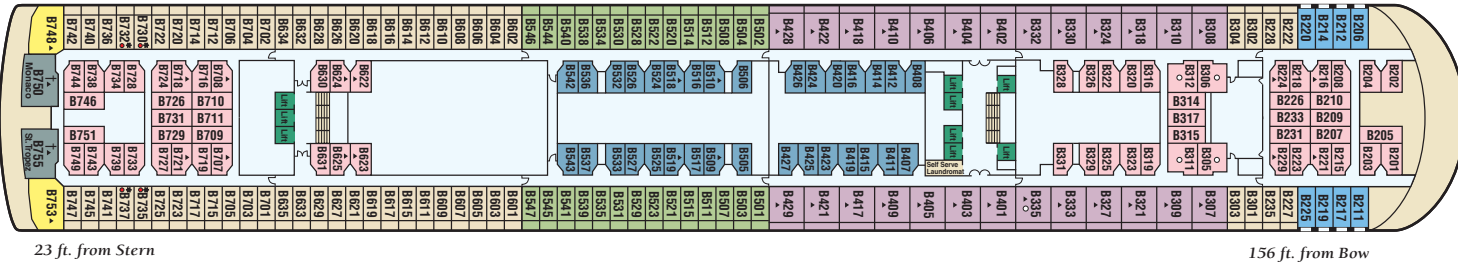

Caribe 9

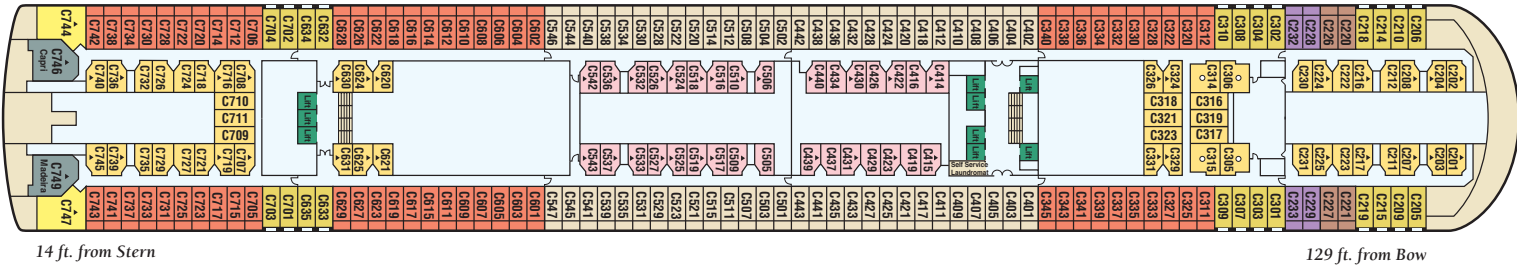

Dolphin 8

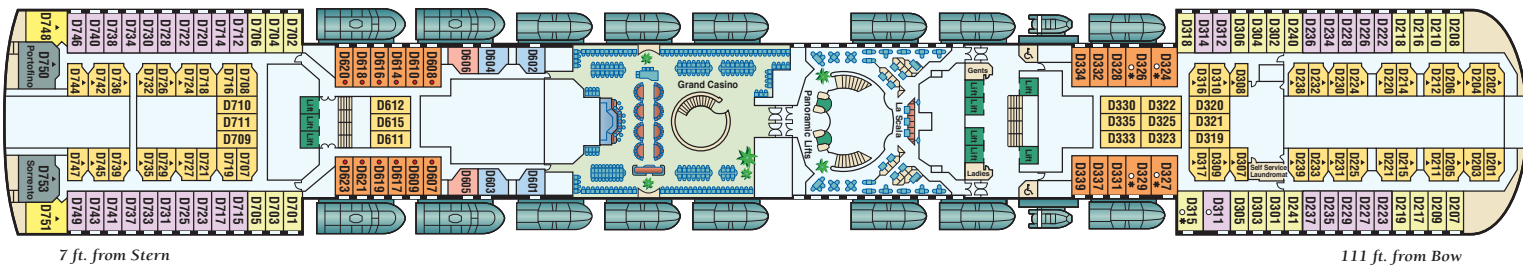

# DAWN PRINCESS DECK PLANS

← AFT

FORWARD →

## Promenade 7

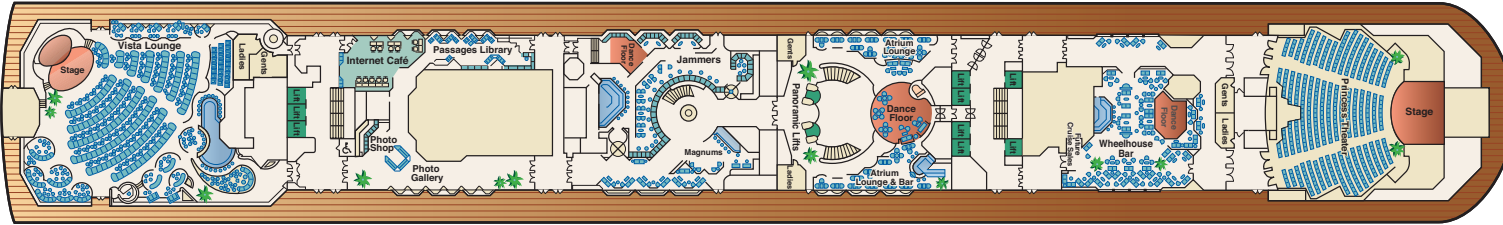

## Emerald 6

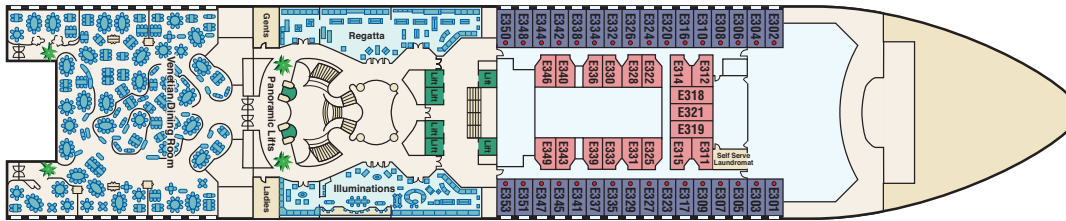

530 ft. from Stern 208 ft. from Bow

## Plaza 5

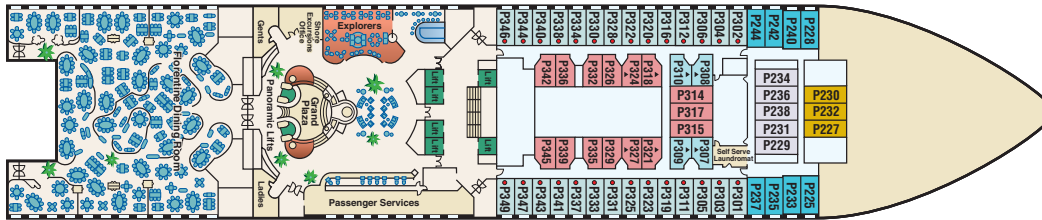

530 ft. from Stern 176 ft. from Bow

## Fiesta 4

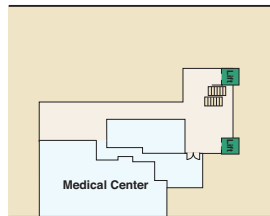

### STATEROOM DESCRIPTION

- AA BAJA, CARIBE, DOLPHIN: Suite with queen-size bed and balcony
- AB BAJA, CARIBE, DOLPHIN: Mini-suite with queen-size bed and balcony
- AC BAJA: Mini-suite with queen-size bed and balcony
- BA ALOHA, RIVIERA: Balcony two lower beds
- BB ALOHA, BAJA: Balcony two lower beds
- BC BAJA, CARIBE: Balcony two lower beds
- BD CARIBE: Balcony two lower beds
- BE CARIBE: Balcony two lower beds
- BF CARIBE: Balcony two lower beds
- CC ALOHA: Deluxe oceanview two lower beds
- C BAJA: Deluxe oceanview two lower beds
- DD CARIBE: Deluxe oceanview two lower beds
- D DOLPHIN: Oceanview two lower beds
- EE DOLPHIN: Oceanview two lower beds
- E EMERALD: Oceanview two lower beds
- FF PLAZA: Oceanview two lower beds
- F PLAZA: Oceanview two lower beds
- GG DOLPHIN: Oceanview two lower beds (obstructed view)
- G DOLPHIN: Oceanview two lower beds (obstructed view)
- HH DOLPHIN: Oceanview two lower beds (obstructed view)
- I ALOHA, RIVIERA: Interior two lower beds
- I ALOHA, BAJA: Interior two lower beds
- J BAJA, CARIBE: Interior two lower beds
- J CARIBE, DOLPHIN: Interior two lower beds
- K EMERALD, PLAZA: Interior two lower beds
- L PLAZA: Interior two lower beds
- M PLAZA: Interior two lower beds
- N PLAZA: Interior two lower beds

visit [princess.com](http://princess.com) for virtual tours and photos of staterooms

◦ Wheelchair-accessible stateroom • Will accommodate third and fourth person \* Will accommodate third person \* Two lower beds not convertible to queen

Note: Some areas of the ship are not accessible to wheelchairs and scooters.